

KAIN ROAD PROPERTY MASTER PLAN

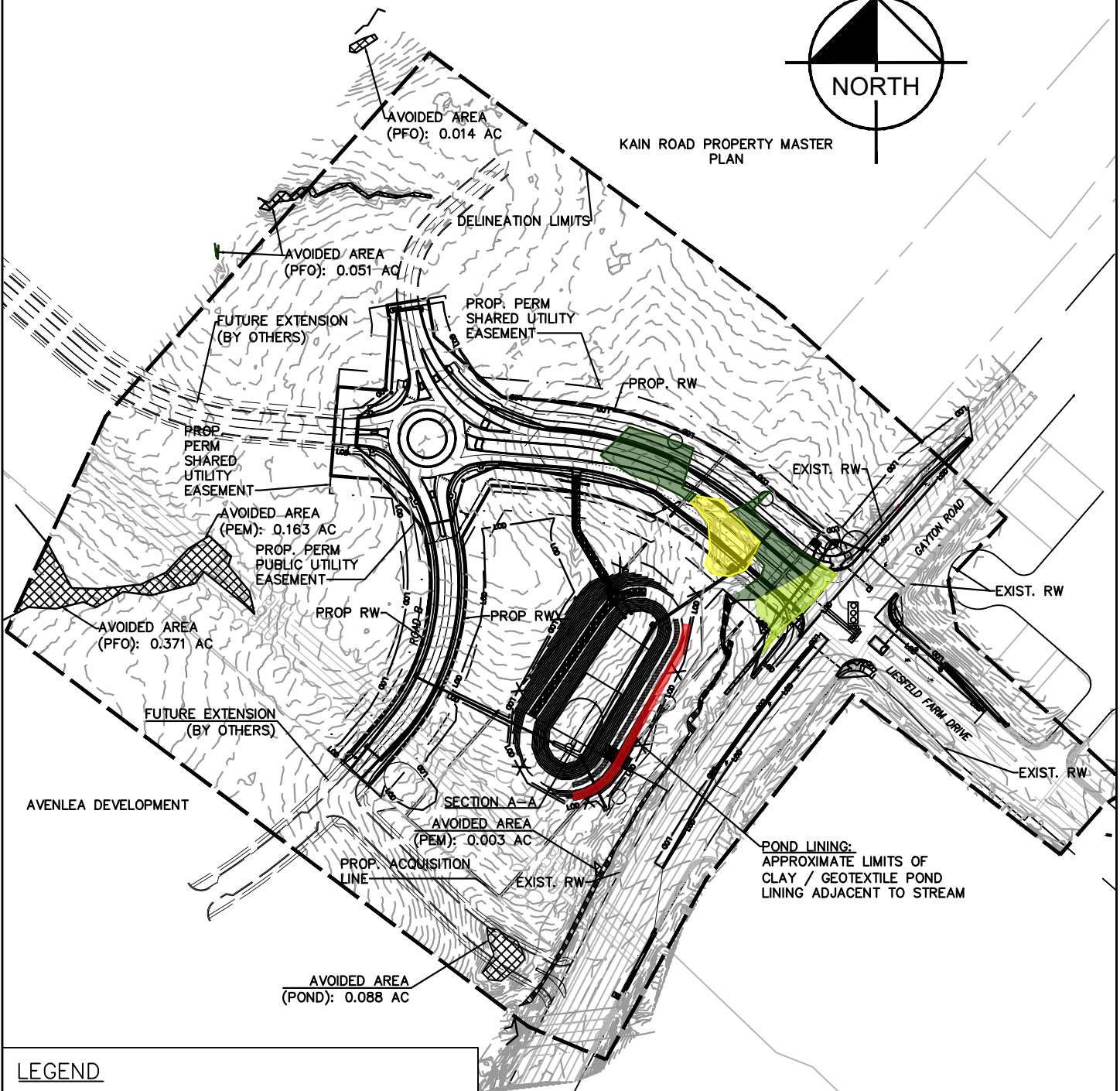

LEGEND

- PFO PERMANENT WETLAND IMPACT - 19552 SF
- PEM PERMANENT WETLAND IMPACT - 7523 SF
- POW PERMANENT IMPACT - 8405 SF
- AVOIDED WETLANDS - 30920 SF
- AVOIDED STREAMS - 950 LF
- LIMITS OF DISTURBANCE - 412136 SF

--- DELINEATION LIMITS: 1592412 SQ. FT. (36.6 AC)

ENVIRONMENTAL SUMMARY
 TOTAL WETLAND & WATERS IMPACTS:
 35,480 SF (0.81 AC)

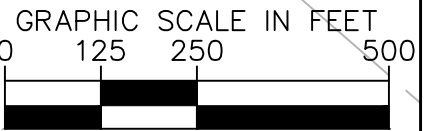

PURPOSE: ROADWAY EXTENSION
 COUNTY: HENRICO COUNTY, VA
 APP BY: HENRICO COUNTY
 HUC: 020802050605

WETLAND IMPACT DRAWING
 LIESFELD FARM DRIVE EXTENSION



CREATED BY: OM
 SCALE: 1"=250'
 DATE: 02/7/24 REVISED: 6/4/24
 SHEET: 1