

SAMPLE AND BUILDING INSPECTION REPORT

Client: Rock Island, Installation-wide Asbestos Survey, Phase VI, Quadrants 1, 2, 3, and 4

Location: 6
 Building Use/Description: Colonel housing
 AVG. # People/Hr: 4
 AVG. # Hrs/Day: 14
 AVG. # Days/Year: 340
 AVG. # Person Hrs/Year: 19040

Date: 1/7/1997
 Inspectors: S. Lynn, J. Romine

Type of Material	Suspect ACBM	Sample No.	*Quantity	Condition	Friable	Physical	Air	Vibration	Water	Hazard Rank
0.5"x 1" square white and grey linoleum	Yes	64RIA 6.9.3.1 - ND	620 sf	Good	No	Moderate	Low	Low	Low	2
4" beige with floral linoleum	Yes	57RIA 6.4.1.1 - ND	760 sf	Good	No	Moderate	Low	Low	Low	2
4" beige with floral linoleum	Yes	58RIA 6.4.1.2 - ND	760 sf	Good	No	Moderate	Low	Low	Low	2
Asbestos paper above boiler	Yes	54RIA 6.1.B.1 - 50% CH (QC 80% CH)	30 sf	Fair	Yes	Low	Low	Low	Low	4
Felt paper on basement ceiling	Yes	56RIA 6.3.B.1 - ND	20 sf	Good	No	Low	Low	Low	Low	1
Fireplace caulk	Yes	62RIA 6.8.2.1 - ND	3 sf	Fair	Yes	Low	Low	Low	Low	4
Green/brown/orange linoleum	Yes	65RIA 6.10.3.1 - ND	900 sf	Good	No	Moderate	Low	Low	Low	2
Green/brown/orange linoleum	Yes	66RIA 6.10.3.2 - ND	900 sf	Good	No	Moderate	Low	Low	Low	2
Hexagonal white linoleum	Yes	59RIA 6.5.1.1 - ND	120 sf	Good	No	Moderate	Low	Low	Low	2
Plaster	Yes	55RIA 6.2.B.1 - < 1% CH		Good	No	Low	Low	Low	Low	1
Plaster	Yes	61RIA 6.7.2.1 - ND		Good	No	Low	Low	Low	Low	1
Plaster	Yes	63RIA 6.7.2.2 - ND		Good	No	Low	Low	Low	Low	1

Notes:

ACBM = Asbestos-containing building material
 CH = Chrysotile
 AM = Amosite
 CR = Crocidolite
 DCW = Domestic cold water
 DHW = Domestic hot water
 ND = Not detected
 Dup = Duplicate

psi = Pounds per square inch
 TSI = Thermal system insulation
 FT = Floor tile
 CT = Ceiling tile
 CBM = Cove base molding
 lf = Linear feet
 sf = Square feet
 NA = No sample collected

*Quantities listed are totals per homogeneous area, unless otherwise indicated in the description of the material.

SAMPLE AND BUILDING INSPECTION REPORT

Client: Rock Island, Installation-wide Asbestos Survey, Phase VI, Quadrants 1, 2, 3, and 4

Location: 6
 Building Use/Description: Colonel housing
 AVG. # People/Hr: 4
 AVG. # Hrs/Day: 14
 AVG. # Days/Year: 340
 AVG. # Person Hrs/Year: 19040

Date: 1/7/1997
 Inspectors: S. Lynn, J. Romine

Type of Material	Suspect ACBM	Sample No.	*Quantity	Condition	Friable	Physical	Air	Vibration	Water	Hazard Rank
Plaster	Yes	67RIA 6.4.3.3 - ND		Good	No	Low	Low	Low	Low	1
Tan terra cotta linoleum	Yes	60RIA 6.6.2.1 - 15% CH	130 sf	Good	No	Moderate	Low	Low	Low	2

Notes:

ACBM = Asbestos-containing building material psi = Pounds per square inch
 CH = Chrysotile TSI = Thermal system insulation
 AM = Amosite FT = Floor tile
 CR = Crocidolite CT = Ceiling tile
 DCW = Domestic cold water CBM = Cove base molding
 DHW = Domestic hot water lf = Linear feet
 ND = Not detected sf = Square feet
 Dup = Duplicate NA = No sample collected

*Quantities listed are totals per homogeneous area, unless otherwise indicated in the description of the material.

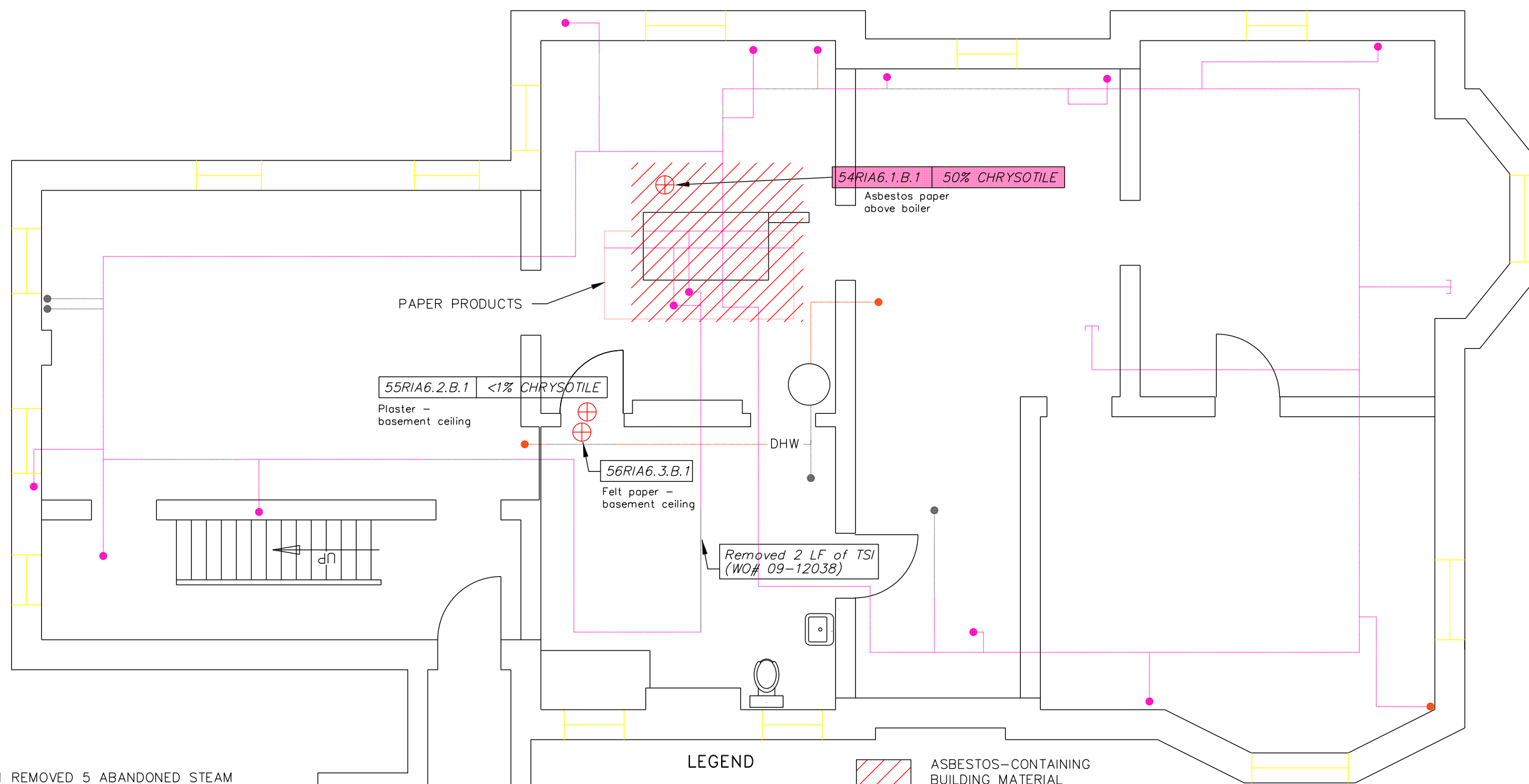

NOTES:

1. 11/10/2011 REMOVED 5 ABANDONED STEAM LINES INTACT. REPAIRED ALL EXPOSED ENDS OF PIPE INSULATION. ALL TSI (PIPE COVERING) CONTAINS ASBESTOS UNLESS OTHERWISE IDENTIFIED.
2. 11/11/2011 REMOVED 5 ABANDONED STEAM LINES INTACT. REPAIRED ALL EXPOSED ENDS OF ASBESTOS CONTAINING PIPE INSULATION.
3. VARIOUS SECTIONS OF ABANDONED ASBESTOS COVERED STEAM LINES WERE REMOVED BY SUB-CONTRACTOR TO ALLOW SPACE FOR AIR VENTS.
4. ABANDONED STEAM LINES SHOULD BE REMOVED OR ABATED.

LEGEND

- ▲ WALL SAMPLE
- ✕ FLOOR SAMPLE
- ⊕ CEILING SAMPLE
- RISER
- ▨ ASBESTOS-CONTAINING BUILDING MATERIAL
- STEAM SERVICE
- DCW — DOMESTIC COLD WATER
- DHW — DOMESTIC HOT WATER
- DEAD END
- ABATED TSI LINE

118RIA81.4.B.1 35% CHRYSOTILE

ALL SHADED BOXES INDICATE ASBESTOS-CONTAINING MATERIAL

% AND TYPE OF ASBESTOS FOUND (NO PERCENTAGE NUMBER INDICATES ASBESTOS NOT DETECTED)

SAMPLE NUMBER WITHIN SPECIFIC HOMOGENEOUS AREA

FLOOR OF BUILDING

NUMBER OF HOMOGENEOUS AREA

BUILDING NUMBER

SAMPLE IDENTIFICATION NUMBER

ABBREVIATIONS

- FG = FIBERGLASS
- MAG = MAGNESIUM
- TSI = THERMAL SYSTEM INSULATION

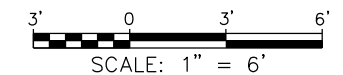



REVISION DATE: SEPTEMBER 2014

ROCK ISLAND ARSENAL
INSTALLATION-WIDE ASBESTOS SURVEY
PHASE II - QUADRANT 1
ROCK ISLAND, ILLINOIS

FIGURE 6-FB
BUILDING 006 - BASEMENT
SAMPLE LOCATIONS AND ASBESTOS
CONTAINING HOMOGENOUS AREAS



LEGEND

-  WALL SAMPLE
-  FLOOR SAMPLE
-  CEILING SAMPLE

118RIA81.4.B.1 35% CHRYSOTILE

% AND TYPE OF ASBESTOS FOUND
(NO PERCENTAGE NUMBER INDICATES
ASBESTOS NOT DETECTED)

SAMPLE NUMBER WITHIN
SPECIFIC HOMOGENEOUS AREA

FLOOR OF BUILDING

NUMBER OF HOMOGENEOUS AREA

BUILDING NUMBER

SAMPLE IDENTIFICATION NUMBER

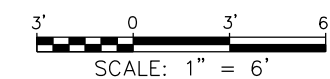
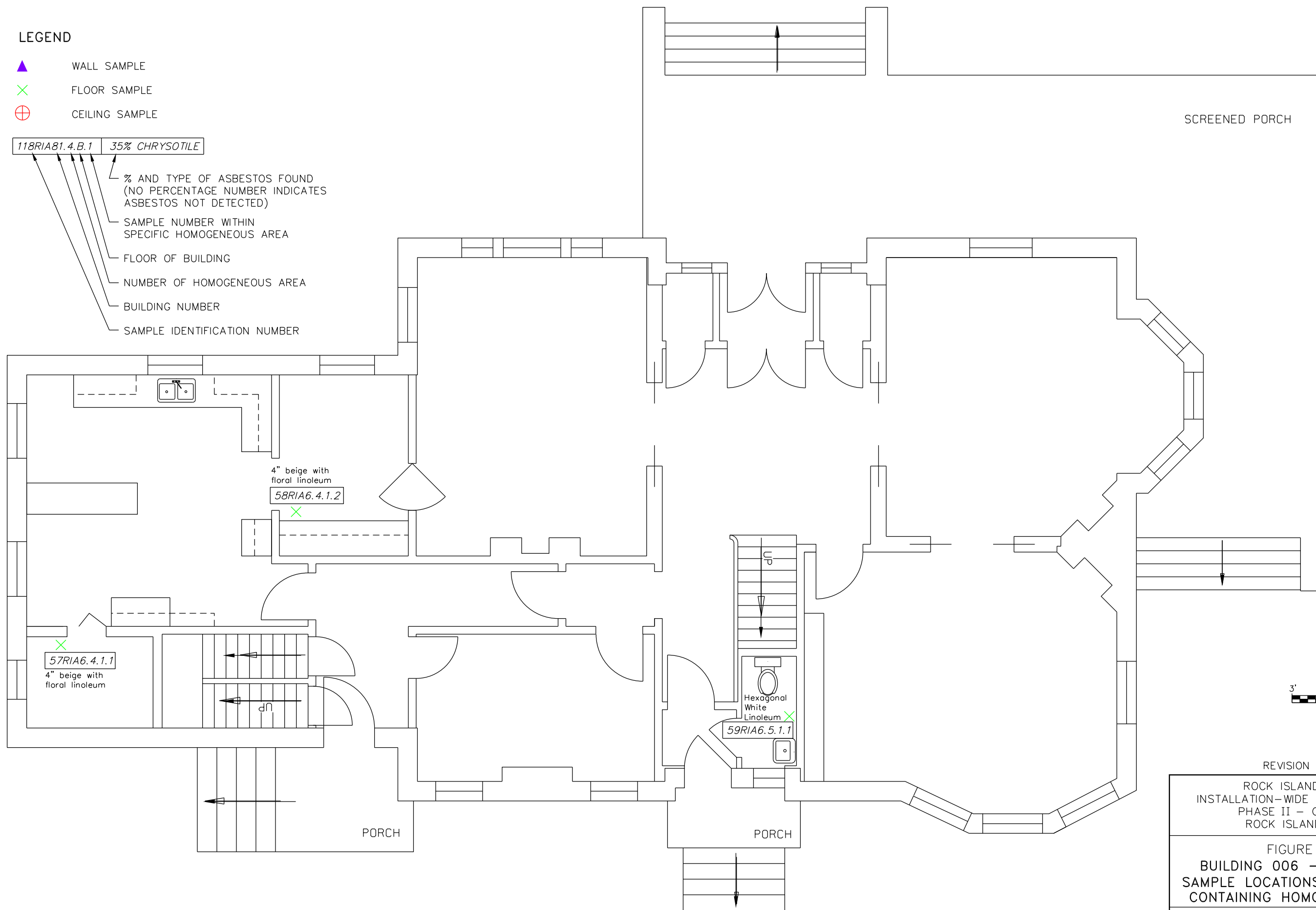

REVISION DATE: SEPTEMBER 2014

ROCK ISLAND ARSENAL
INSTALLATION-WIDE ASBESTOS SURVEY
PHASE II - QUADRANT 1
ROCK ISLAND, ILLINOIS

FIGURE 6-F1
BUILDING 006 - FIRST FLOOR
SAMPLE LOCATIONS AND ASBESTOS
CONTAINING HOMOGENOUS AREAS

PRC ENVIRONMENTAL MANAGEMENT, INC.



BROWN WOOD GRAINED LINOLEUM
SAMP. # 6-7-FCT (NO ASBESTOS DETECTED).

TARPAPER UNDER LINOLEUM
SAMP. # 6-7-3TP (NO ASBESTOS DETECTED).

60RIA6.4.B.1 15% CHRYSOTILE
tan terra cotta linoleum

61RIA6.7.2.1
Plaster -
2nd floor bathroom

TAN TERRA COTTA
LINOLEUM

TAN TERRA COTTA LINOLEUM (TOP LAYER)
15% ASBESTOS (CHRYSOTILE)
GREEN FLOOR COVERING UNDER SUB-FLOOR
NO ASBESTOS DETECTED.

50 s.f.
Tan terra cotta
Linoleum

Plaster - 2nd
floor bedroom
63RIA6.7.2.2

Fireplace caulk -
2nd floor
62RIA6.8.2.1

WHITE/BEIGE LINOLEUM (TOP LAYER)
SAMP. # 6-7-1LT (NO ASBESTOS DETECTED)
GREEN/TAN LINOLEUM UNDER WHITE LINOLEUM
SAMP. # 6-7-1LB 5% ASBESTOS (CHRYSOTILE)

3' 0 3' 6'
SCALE: 1" = 6'

LEGEND

- ▲ WALL SAMPLE
- ✕ FLOOR SAMPLE
- ⊕ CEILING SAMPLE
- ▨ ASBESTOS-CONTAINING BUILDING MATERIAL

ASSUMED ASBESTOS-CONTAINING BUILDING MATERIAL AREA
(NOTE: Assumption based on positive samples of similar building materials taken at corresponding locations in other building)

118RIA81.4.B.1 35% CHRYSOTILE

ALL SHADED BOXES INDICATE ASBESTOS-CONTAINING MATERIAL

- % AND TYPE OF ASBESTOS FOUND (NO PERCENTAGE NUMBER INDICATES ASBESTOS NOT DETECTED)
- SAMPLE NUMBER WITHIN SPECIFIC HOMOGENEOUS AREA
- FLOOR OF BUILDING
- NUMBER OF HOMOGENEOUS AREA
- BUILDING NUMBER
- SAMPLE IDENTIFICATION NUMBER

REVISION DATE: SEPTEMBER 2014



ROCK ISLAND ARSENAL
INSTALLATION-WIDE ASBESTOS SURVEY
PHASE II - QUADRANT 1
ROCK ISLAND, ILLINOIS

FIGURE 6-F2
BUILDING 006 - SECOND FLOOR
SAMPLE LOCATIONS AND ASBESTOS
CONTAINING HOMOGENEOUS AREAS

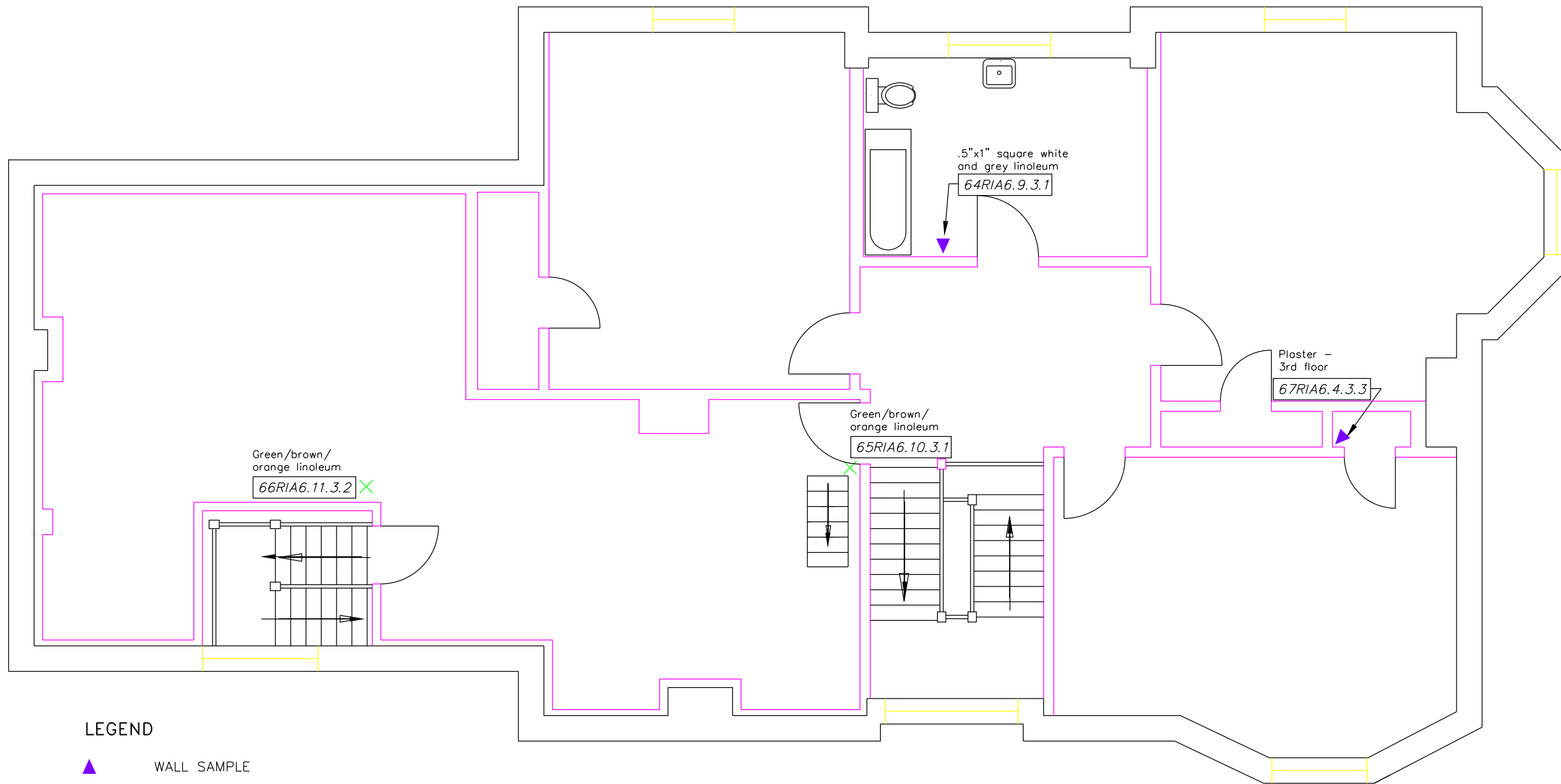
PRC ENVIRONMENTAL MANAGEMENT, INC.



LEGEND

-  WALL SAMPLE
-  FLOOR SAMPLE
-  CEILING SAMPLE

118RIA81.4.B.1 35% CHRYSOTILE

- % AND TYPE OF ASBESTOS FOUND (NO PERCENTAGE NUMBER INDICATES ASBESTOS NOT DETECTED)
- SAMPLE NUMBER WITHIN SPECIFIC HOMOGENEOUS AREA
- FLOOR OF BUILDING
- NUMBER OF HOMOGENEOUS AREA
- BUILDING NUMBER
- SAMPLE IDENTIFICATION NUMBER

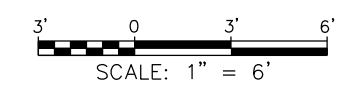

REVISION DATE: SEPTEMBER 2014

ROCK ISLAND ARSENAL
 INSTALLATION-WIDE ASBESTOS SURVEY
 PHASE II - QUADRANT 1
 ROCK ISLAND, ILLINOIS

FIGURE 6-F3
 BUILDING 006 - THIRD FLOOR
 SAMPLE LOCATIONS AND ASBESTOS
 CONTAINING HOMOGENOUS AREAS

PRC ENVIRONMENTAL MANAGEMENT, INC.