

## SAMPLE AND BUILDING INSPECTION REPORT

**Client: Rock Island, Installation-wide Asbestos Survey, Phase VI, Quadrants 1, 2, 3, and 4**

Location: 4  
 Building Use/Description: Colonel housing  
 AVG. # People/Hr: 2  
 AVG. # Hrs/Day: 14  
 AVG. # Days/Year: 340  
 AVG. # Person Hrs/Year: 9520

Date: 1/9/1997  
 Inspectors: S. Lynn, J. Romine

Type of Material	Suspect ACBM	Sample No.	*Quantity	Condition	Friable	Physical	Air	Vibration	Water	Hazard Rank
5"x 5" beige floral linoleum	Yes	87ARIA 4.2A.1.1 - ND	660 sf	Good	No	Moderate	Low	Low	Low	2
5" x 5" beige floral linoleum	Yes	88RIA 4.2.1.2 - ND	660 sf	Good	No	Moderate	Low	Low	Low	2
9" green with white streaks FT	Yes	91RIA 4.5.2.1-A - 2% CH (QC 15% CH)	60 sf	Good	No	Moderate	Low	Low	Low	2
Mastic	Yes	91RIA 4.5.2.1-B - 3% CH (QC 2% CH)	60 sf	Good	No	Moderate	Low	Low	Low	2
Plaster	Yes	86BRIA 4.1.B.1 - ND		Good	No	Low	Low	Low	Low	1
Plaster	Yes	92RIA 4.1.2.2 - ND		Good	No	Low	Low	Low	Low	1
Plaster	Yes	94RIA 4.1.2.3 - ND		Good	No	Low	Low	Low	Low	1
Speckled sheet vinyl	Yes	87BRIA 4.2B.1.1 - 10% CH	180 sf	Good	No	Moderate	Low	Low	Low	2
White wallpaper	Yes	93RIA 4.6.2.1 - ND	1,320 sf	Good	No	Low	Low	Low	Low	1
Yellow speckled linoleum	Yes	89RIA 4.3.1.1 - 20% CH	150 sf	Good	No	Moderate	Low	Low	Low	2

**Notes:**

ACBM = Asbestos-containing building material  
 CH = Chrysotile  
 AM = Amosite  
 CR = Crocidolite  
 DCW = Domestic cold water  
 DHW = Domestic hot water  
 ND = Not detected  
 Dup = Duplicate

psi = Pounds per square inch  
 TSI = Thermal system insulation  
 FT = Floor tile  
 CT = Ceiling tile  
 CBM = Cove base molding  
 lf = Linear feet  
 sf = Square feet  
 NA = No sample collected

\*Quantities listed are totals per homogeneous area, unless otherwise indicated in the description of the material.



### LEGEND

- ▲ WALL SAMPLE
- ✕ FLOOR SAMPLE
- ⊕ CEILING SAMPLE
- RISER
- DCW— DOMESTIC COLD WATER
- DHW— DOMESTIC HOT WATER
- UNINSULATED OR FIBERGLASS PIPING
- ABATED TSI LINE

**118RIA81.4.B.1**    **35% CHRYSOTILE**

% AND TYPE OF ASBESTOS FOUND  
(NO PERCENTAGE NUMBER INDICATES ASBESTOS NOT DETECTED)

SAMPLE NUMBER WITHIN SPECIFIC HOMOGENEOUS AREA

FLOOR OF BUILDING

NUMBER OF HOMOGENEOUS AREA

BUILDING NUMBER

SAMPLE IDENTIFICATION NUMBER

### ABBREVIATIONS

- FG = FIBERGLASS
- MAG = MAGNESIUM
- TSI = THERMAL SYSTEM INSULATION

### NOTES:

1. MAJORITY OF PIPE INSULATION IS AIR CELL WITH ASBESTOS CONTAINING ELBOWS.
2. ALL TSI (PIPE COVERING) CONTAINS ASBESTOS UNLESS OTHERWISE IDENTIFIED.
3. MOST RETURN LINS WERE UNINSULATED (NOT SHOWN ON DIAGRAM).
4. AIRCELL IS ASSUMED TO CONTAIN CHRYSOTILE ASBESTOS.
5. ALL KNOWN ASBESTOS CONTAINING PIPE INSULATION WAS REMOVED.

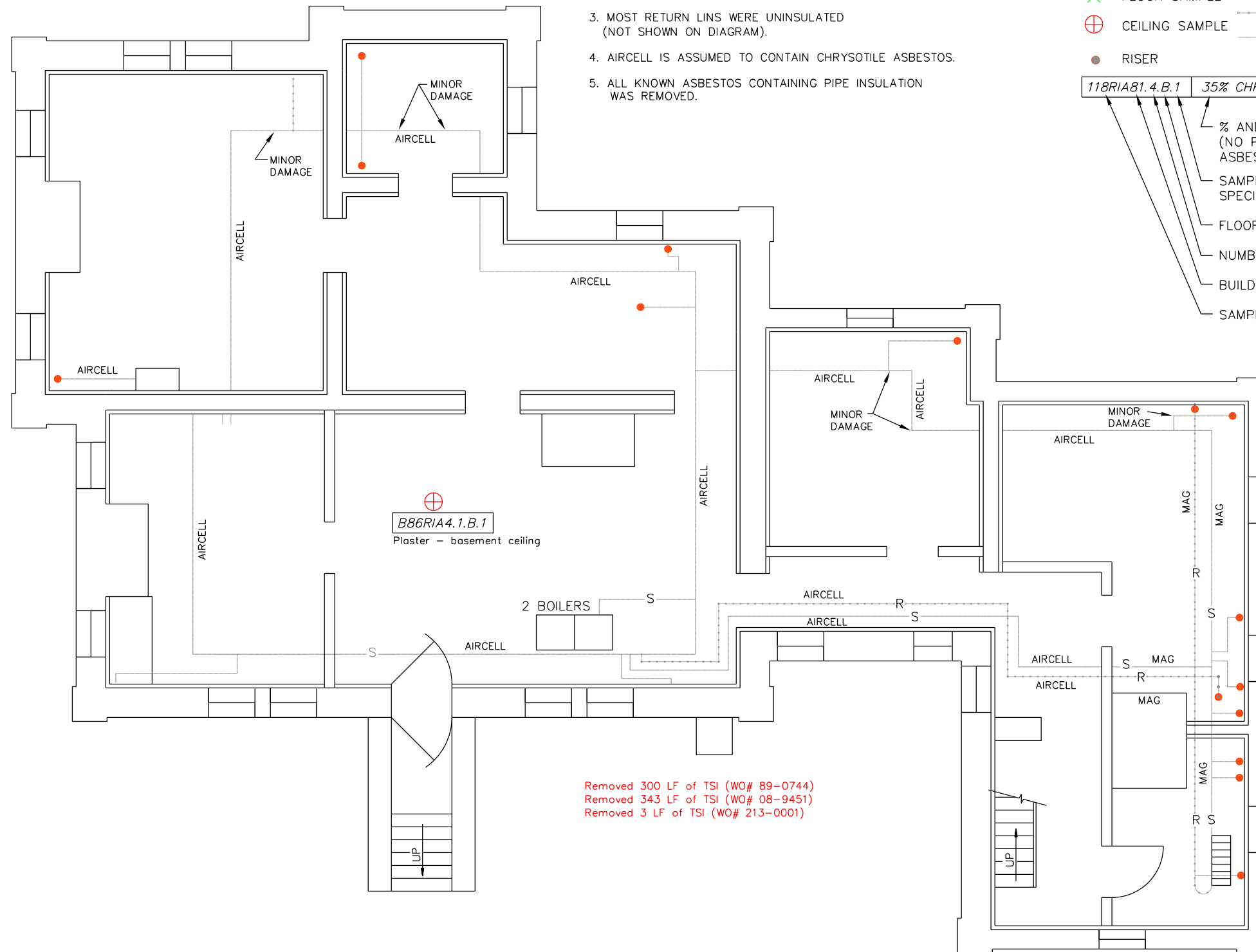

REVISION DATE: SEPTEMBER 2014



ROCK ISLAND ARSENAL  
INSTALLATION-WIDE ASBESTOS SURVEY  
PHASE II - QUADRANT 1  
ROCK ISLAND, ILLINOIS

FIGURE 4-FB  
BUILDING 004 - BASEMENT  
SAMPLE LOCATIONS AND ASBESTOS  
CONTAINING HOMOGENEOUS AREAS



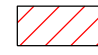
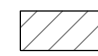

**LEGEND**

-  WALL SAMPLE
  -  FLOOR SAMPLE
  -  CEILING SAMPLE
  -  ASBESTOS-CONTAINING BUILDING MATERIAL
  -  ABATED ASBESTOS-CONTAINING BUILDING MATERIAL
- ALL SHADED BOXES INDICATE ASBESTOS-CONTAINING MATERIAL
- % AND TYPE OF ASBESTOS FOUND (NO PERCENTAGE NUMBER INDICATES ASBESTOS NOT DETECTED)
- SAMPLE NUMBER WITHIN SPECIFIC HOMOGENEOUS AREA
- FLOOR OF BUILDING
- NUMBER OF HOMOGENEOUS AREA
- BUILDING NUMBER
- SAMPLE IDENTIFICATION NUMBER

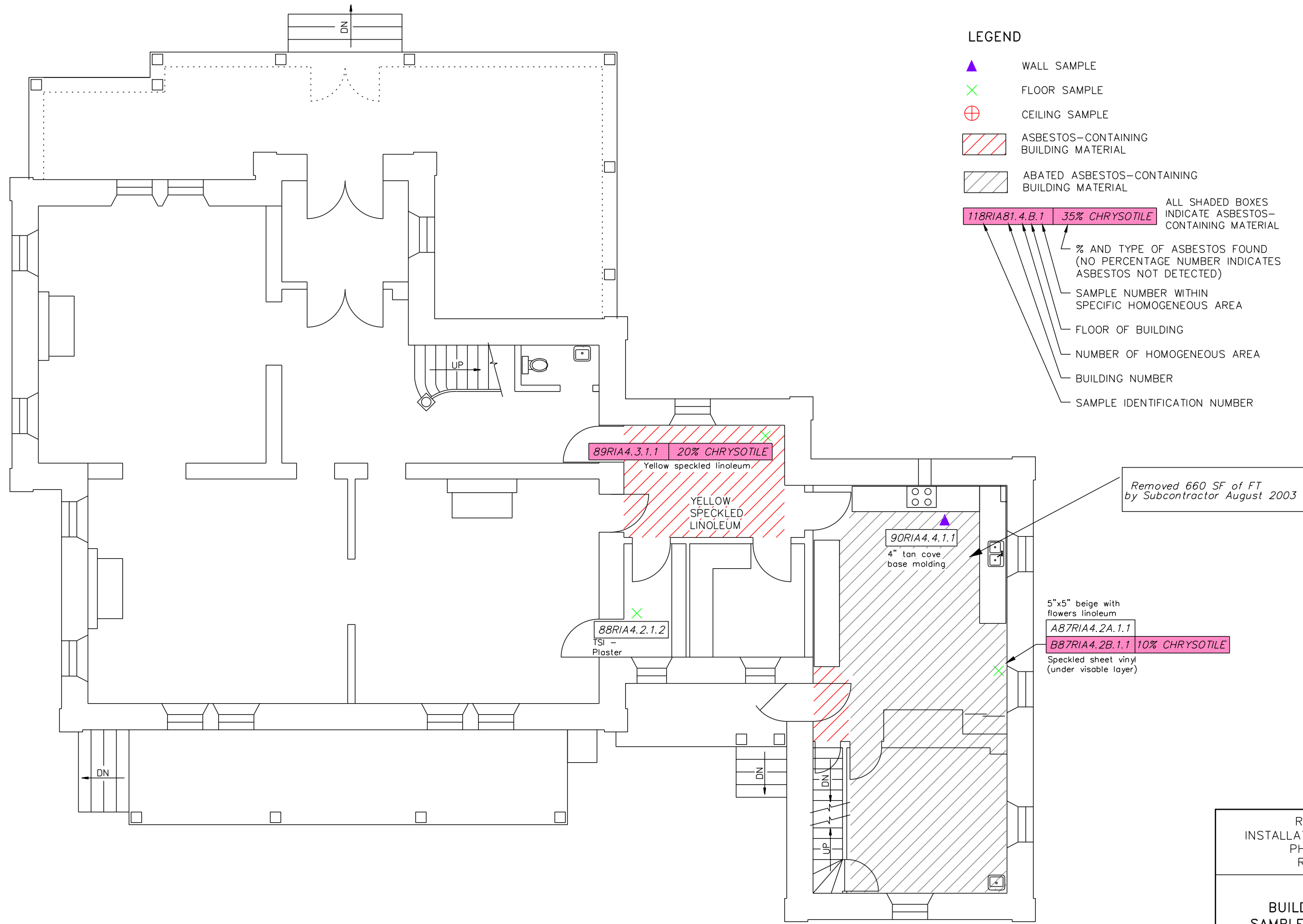





REVISION DATE: SEPTEMBER 2014

ROCK ISLAND ARSENAL  
 INSTALLATION-WIDE ASBESTOS SURVEY  
 PHASE II - QUADRANT 1  
 ROCK ISLAND, ILLINOIS

FIGURE 4-F1  
 BUILDING 004 - FIRST FLOOR  
 SAMPLE LOCATIONS AND ASBESTOS  
 CONTAINING HOMOGENOUS AREAS



**LEGEND**

-  WALL SAMPLE
-  FLOOR SAMPLE
-  CEILING SAMPLE
-  ASBESTOS-CONTAINING BUILDING MATERIAL

**118RIA81.4.B.1 35% CHRYSOTILE**

ALL SHADED BOXES INDICATE ASBESTOS-CONTAINING MATERIAL

% AND TYPE OF ASBESTOS FOUND (NO PERCENTAGE NUMBER INDICATES ASBESTOS NOT DETECTED)

SAMPLE NUMBER WITHIN SPECIFIC HOMOGENEOUS AREA

FLOOR OF BUILDING

NUMBER OF HOMOGENEOUS AREA

BUILDING NUMBER

SAMPLE IDENTIFICATION NUMBER

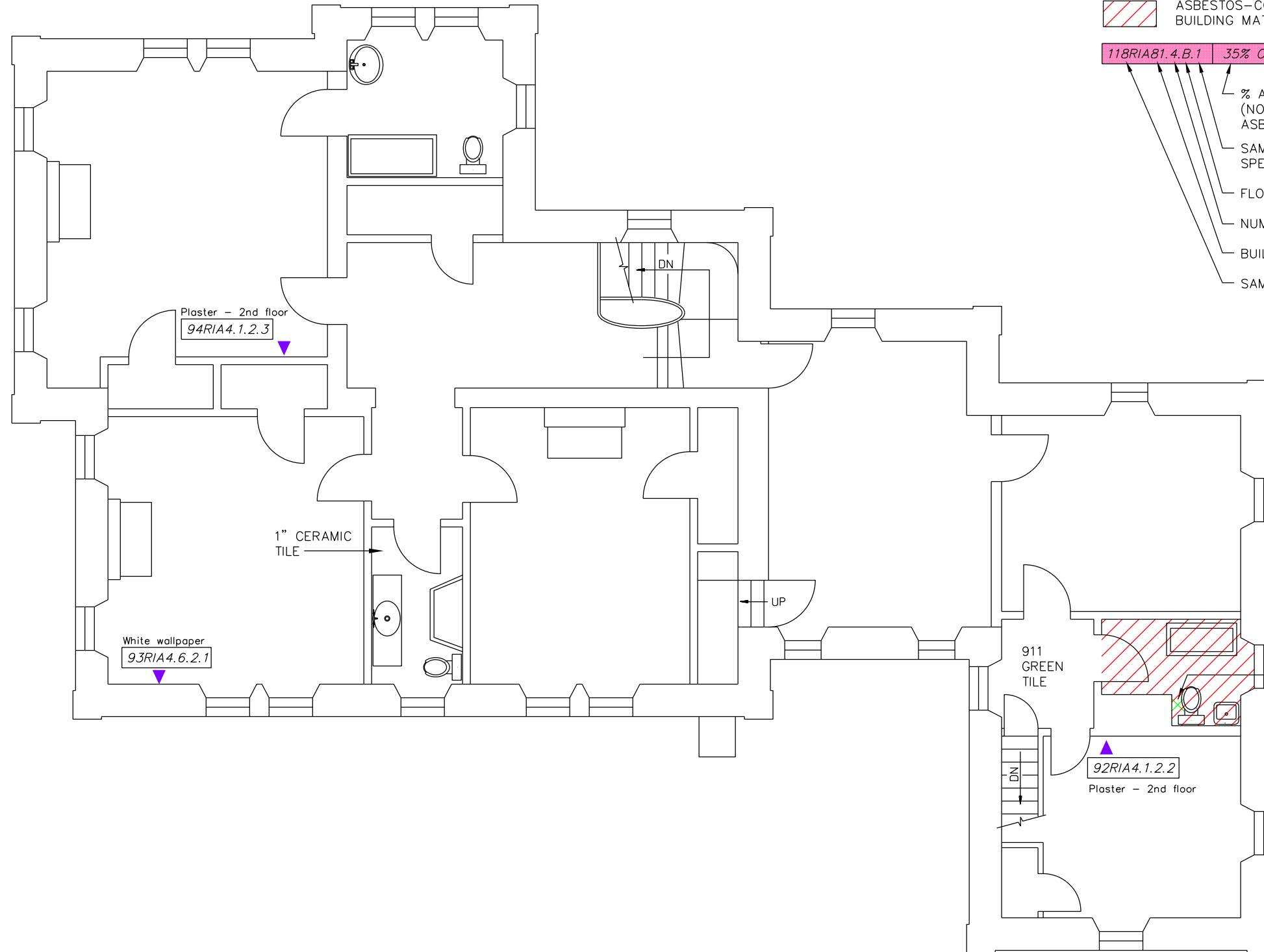

**91RIA4.5.2.1 3% CHRYSOTILE** 9" green with white streaks floor tile  
**91RIA4.5.2.1-A 2% CHRYSOTILE** Mastic



REVISION DATE: SEPTEMBER 2014

ROCK ISLAND ARSENAL  
 INSTALLATION-WIDE ASBESTOS SURVEY  
 PHASE II - QUADRANT 1  
 ROCK ISLAND, ILLINOIS

FIGURE 4-F2  
 BUILDING 004 - SECOND FLOOR  
 SAMPLE LOCATIONS AND ASBESTOS  
 CONTAINING HOMOGENOUS AREAS