

## SAMPLE AND BUILDING INSPECTION REPORT

**Client: Rock Island, Installation-wide Asbestos Survey, Phase VI, Quadrants 1, 2, 3, and 4**

Location: 3  
 Building Use/Description: Colonel housing  
 AVG. # People/Hr: 4  
 AVG. # Hrs/Day: 14  
 AVG. # Days/Year: 340  
 AVG. # Person Hrs/Year: 19040

Date: 1/7/1997  
 Inspectors: S. Lynn, J. Romine

| Type of Material             | Suspect ACBM | Sample No.                    | *Quantity | Condition | Friable | Physical | Air | Vibration | Water | Hazard Rank |
|------------------------------|--------------|-------------------------------|-----------|-----------|---------|----------|-----|-----------|-------|-------------|
| 3" square sandstone linoleum | Yes          | 71RIA 3.2.1.1 - ND (QC ND)    |           | Good      | No      | Moderate | Low | Low       | Low   | 2           |
| 3" square sandstone linoleum | Yes          | 72RIA 3.2.1.2 - ND            |           | Good      | No      | Moderate | Low | Low       | Low   | 2           |
| 9" taupe with brown spots FT | Yes          | 73RIA 3.3.2.1-A - 3% CH       | 45 sf     | Good      | No      | Moderate | Low | Low       | Low   | 2           |
| Mastic                       | Yes          | 73RIA 3.3.2.1-B - 3% CH       | 45 sf     | Good      | No      | Moderate | Low | Low       | Low   | 2           |
| TSI on steam return line     | Yes          | 70RIA 3.1.B.3 - 11% CH, 4% AM | 0         | Fair      | Yes     | Low      | Low | Low       | Low   | 4           |
| TSI on steam supply line     | Yes          | 68RIA 3.1.B.1 - 7% CH         | 0         | Fair      | Yes     | Low      | Low | Low       | Low   | 4           |
| TSI on steam supply line     | Yes          | 69RIA 3.1.B.2 - 5% CH         | 0         | Fair      | Yes     | Low      | Low | Low       | Low   | 4           |

**Notes:**

ACBM = Asbestos-containing building material    psi = Pounds per square inch  
 CH = Chrysotile    TSI = Thermal system insulation  
 AM = Amosite    FT = Floor tile  
 CR = Crocidolite    CT = Ceiling tile  
 DCW = Domestic cold water    CBM = Cove base molding  
 DHW = Domestic hot water    lf = Linear feet  
 ND = Not detected    sf = Square feet  
 Dup = Duplicate    NA = No sample collected

\*Quantities listed are totals per homogeneous area, unless otherwise indicated in the description of the material.

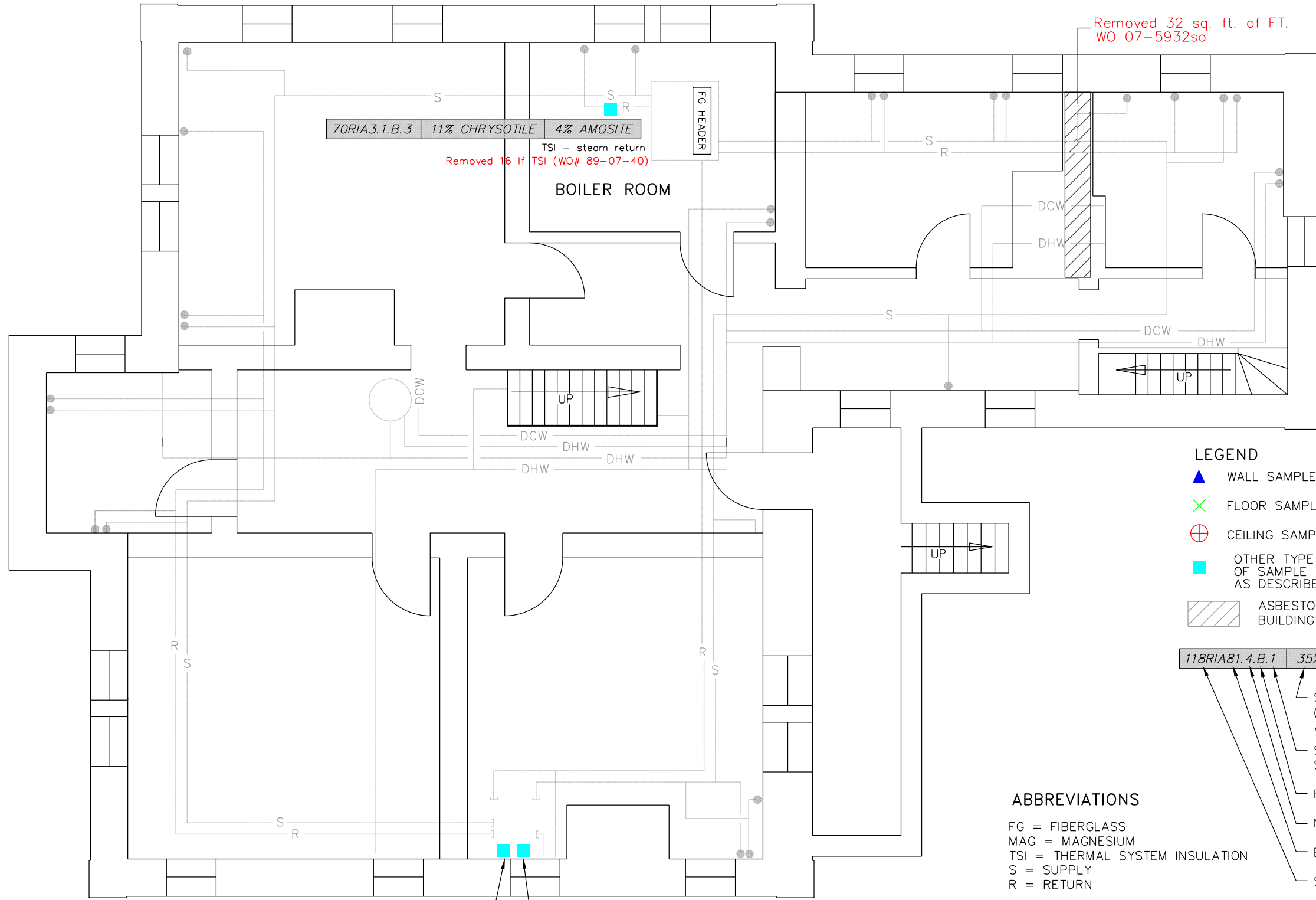
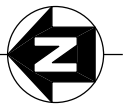

**NOTES:**

1. ALL TSI (PIPE COVERING) CONTAINS ASBESTOS UNLESS OTHERWISE IDENTIFIED.
2. WO #s 11-0391, 11-1032, AND 11-1509: ALL ASBESTOS TSI REMOVED.
3. ALL ASBESTOS COVERED STEAM LINES WERE REMOVED OCT./NOV. 2010 (APPROXIMATE 480 LIN. FT.) S. O. #'S 11-0391, 11-1032 AND 11-1509.
4. ASBESTOS COVERED WATER LINES STILL REMAIN IN BASEMENT AS SHOWN ON FLOOR PLAN.

**LEGEND**

- WALL SAMPLE
- FLOOR SAMPLE
- CEILING SAMPLE
- OTHER TYPE OF SAMPLE AS DESCRIBED
- ASBESTOS-CONTAINING BUILDING MATERIAL
- RISER
- DOMESTIC COLD WATER
- DOMESTIC HOT WATER
- UNINSULATED OR FIBERGLASS PIPING
- DEAD END
- ABATED TSI LINE

ALL SHADED BOXES INDICATE ASBESTOS-CONTAINING MATERIAL

% AND TYPE OF ASBESTOS FOUND (NO PERCENTAGE NUMBER INDICATES ASBESTOS NOT DETECTED)

SAMPLE NUMBER WITHIN SPECIFIC HOMOGENEOUS AREA

FLOOR OF BUILDING

NUMBER OF HOMOGENEOUS AREA

BUILDING NUMBER

SAMPLE IDENTIFICATION NUMBER

**ABBREVIATIONS**

- FG = FIBERGLASS
- MAG = MAGNESIUM
- TSI = THERMAL SYSTEM INSULATION
- S = SUPPLY
- R = RETURN

**68RIA3.1.B.1 7% CHRYSOTILE**  
TSI - steam supply  
Removed 16 If TSI (WO# 89-07-40)

**69RIA3.1.B.2 5% CHRYSOTILE**  
TSI - steam supply  
Removed 16 If TSI (WO# 89-07-40)

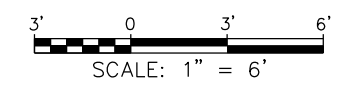

REVISION DATE: SEPTEMBER 2014

ROCK ISLAND ARSENAL  
INSTALLATION-WIDE ASBESTOS SURVEY  
PHASE II - QUADRANT 1  
ROCK ISLAND, ILLINOIS

FIGURE 3-FB  
BUILDING 003 - BASEMENT  
SAMPLE LOCATIONS AND ASBESTOS  
CONTAINING HOMOGENOUS AREAS

**PRC** ENVIRONMENTAL MANAGEMENT, INC.

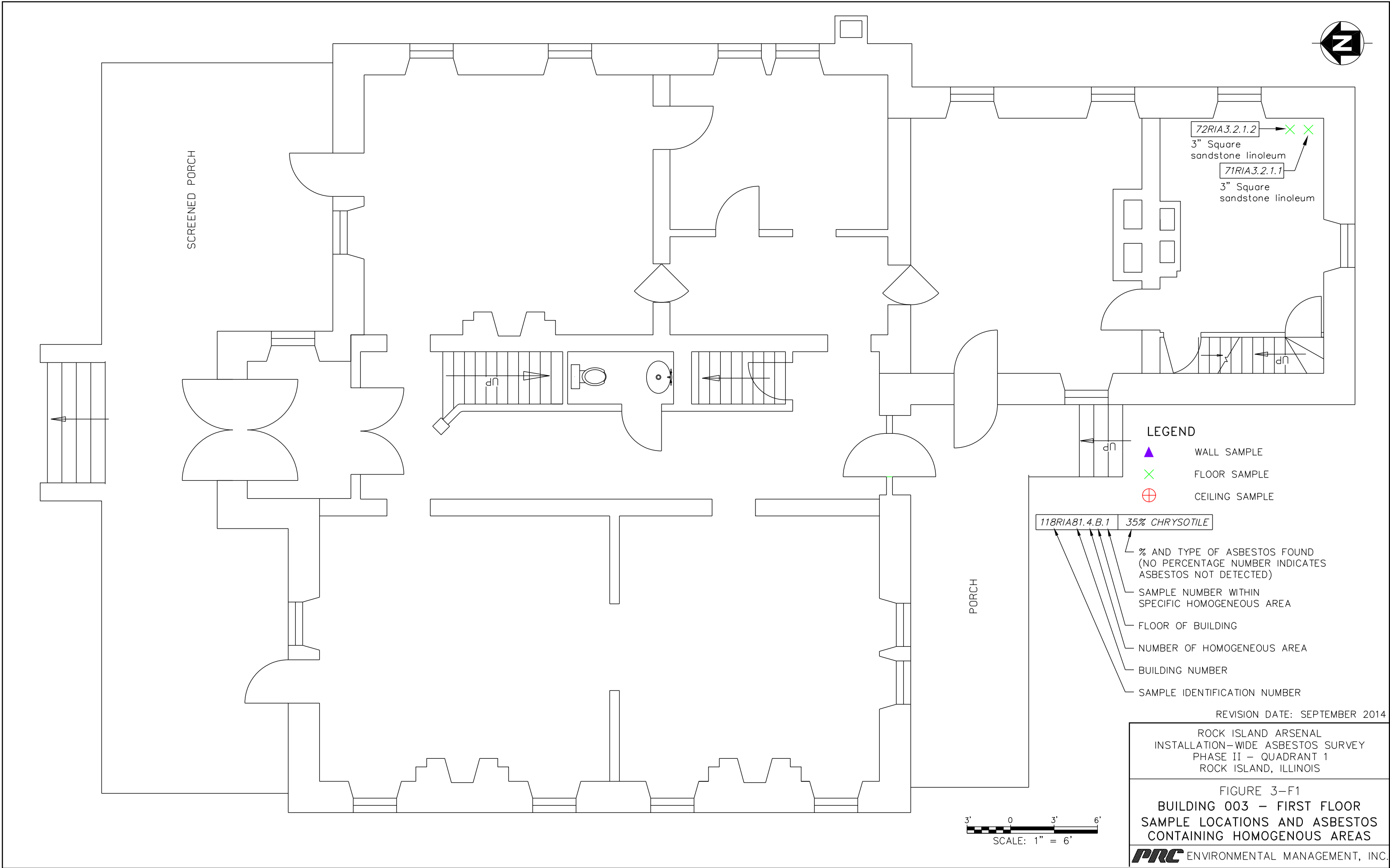

**LEGEND**

- ▲ WALL SAMPLE
- × FLOOR SAMPLE
- ⊕ CEILING SAMPLE

118RIA81.4.B.1 35% CHRYSOTILE

- % AND TYPE OF ASBESTOS FOUND (NO PERCENTAGE NUMBER INDICATES ASBESTOS NOT DETECTED)
- SAMPLE NUMBER WITHIN SPECIFIC HOMOGENEOUS AREA
- FLOOR OF BUILDING
- NUMBER OF HOMOGENEOUS AREA
- BUILDING NUMBER
- SAMPLE IDENTIFICATION NUMBER

REVISION DATE: SEPTEMBER 2014

ROCK ISLAND ARSENAL  
INSTALLATION-WIDE ASBESTOS SURVEY  
PHASE II - QUADRANT 1  
ROCK ISLAND, ILLINOIS

FIGURE 3-F1  
BUILDING 003 - FIRST FLOOR  
SAMPLE LOCATIONS AND ASBESTOS  
CONTAINING HOMOGENEOUS AREAS



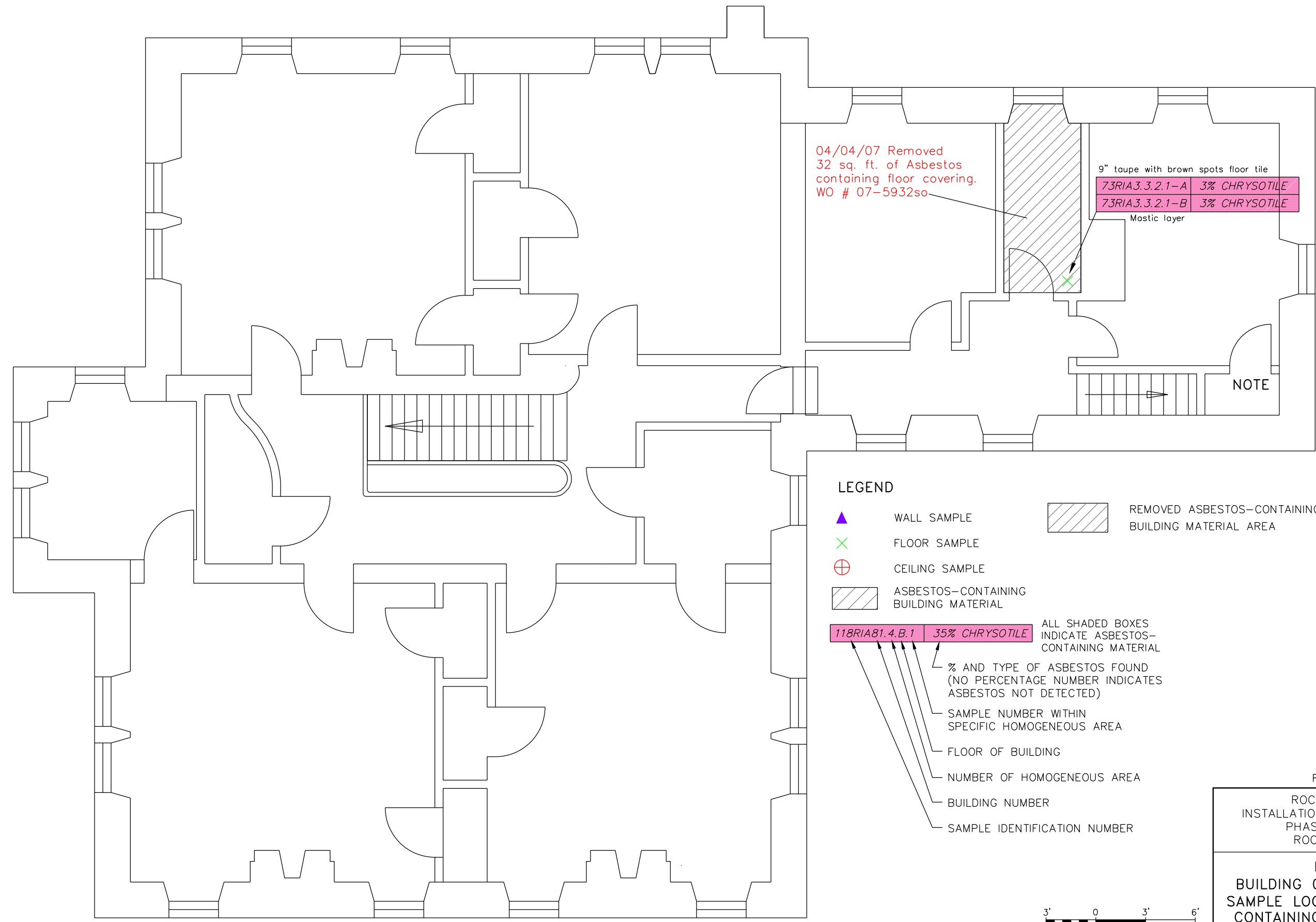

04/04/07 Removed  
32 sq. ft. of Asbestos  
containing floor covering.  
WO # 07-5932so

9" taupe with brown spots floor tile  
73RIA3.3.2.1-A 3% CHRYSOTILE  
73RIA3.3.2.1-B 3% CHRYSOTILE  
Mastic layer

NOTE

**LEGEND**

- WALL SAMPLE
- FLOOR SAMPLE
- CEILING SAMPLE
- ASBESTOS-CONTAINING BUILDING MATERIAL
- REMOVED ASBESTOS-CONTAINING BUILDING MATERIAL AREA

**118RIA81.4.B.1 35% CHRYSOTILE**

ALL SHADED BOXES INDICATE ASBESTOS-CONTAINING MATERIAL

% AND TYPE OF ASBESTOS FOUND (NO PERCENTAGE NUMBER INDICATES ASBESTOS NOT DETECTED)

SAMPLE NUMBER WITHIN SPECIFIC HOMOGENEOUS AREA

FLOOR OF BUILDING

NUMBER OF HOMOGENEOUS AREA

BUILDING NUMBER

SAMPLE IDENTIFICATION NUMBER

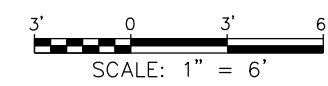

REVISION DATE: SEPTEMBER 2014

ROCK ISLAND ARSENAL  
INSTALLATION-WIDE ASBESTOS SURVEY  
PHASE II - QUADRANT 1  
ROCK ISLAND, ILLINOIS

FIGURE 3-F2  
BUILDING 003 - SECOND FLOOR  
SAMPLE LOCATIONS AND ASBESTOS  
CONTAINING HOMOGENEOUS AREAS

**PRC** ENVIRONMENTAL MANAGEMENT, INC.