

3A  
FIGURE

RIVER CROSS SECTION AT INTAKE  
GREENSVILLE COUNTY  
RAW WATER RESERVOIR & INTAKE

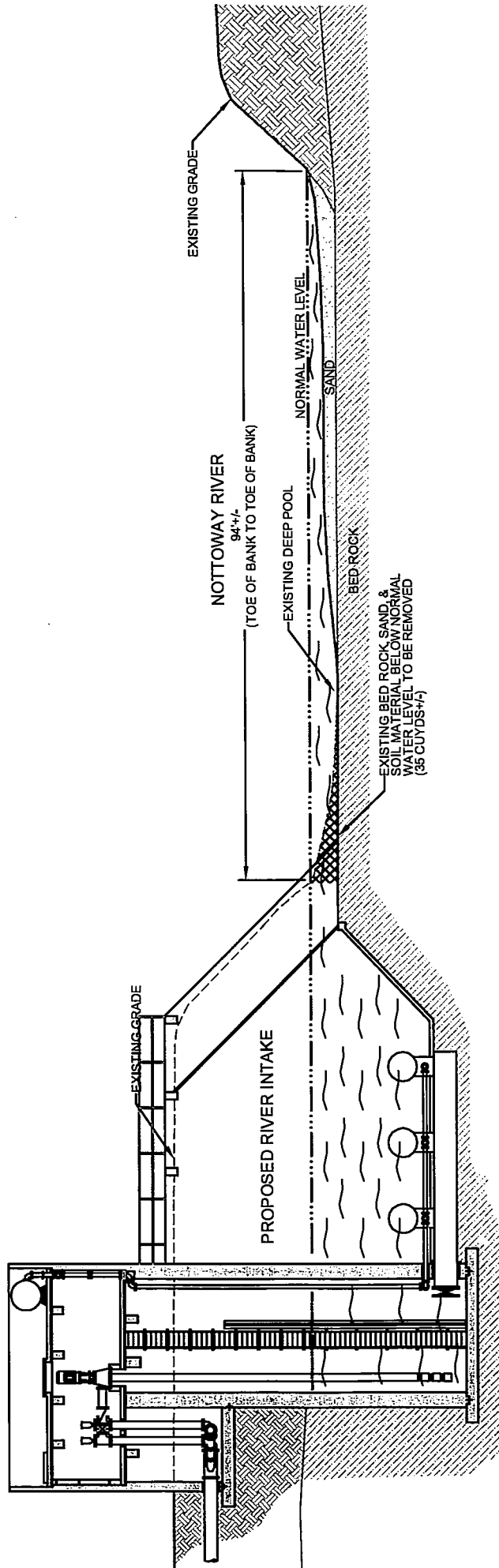

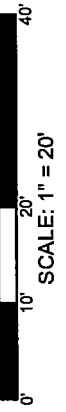
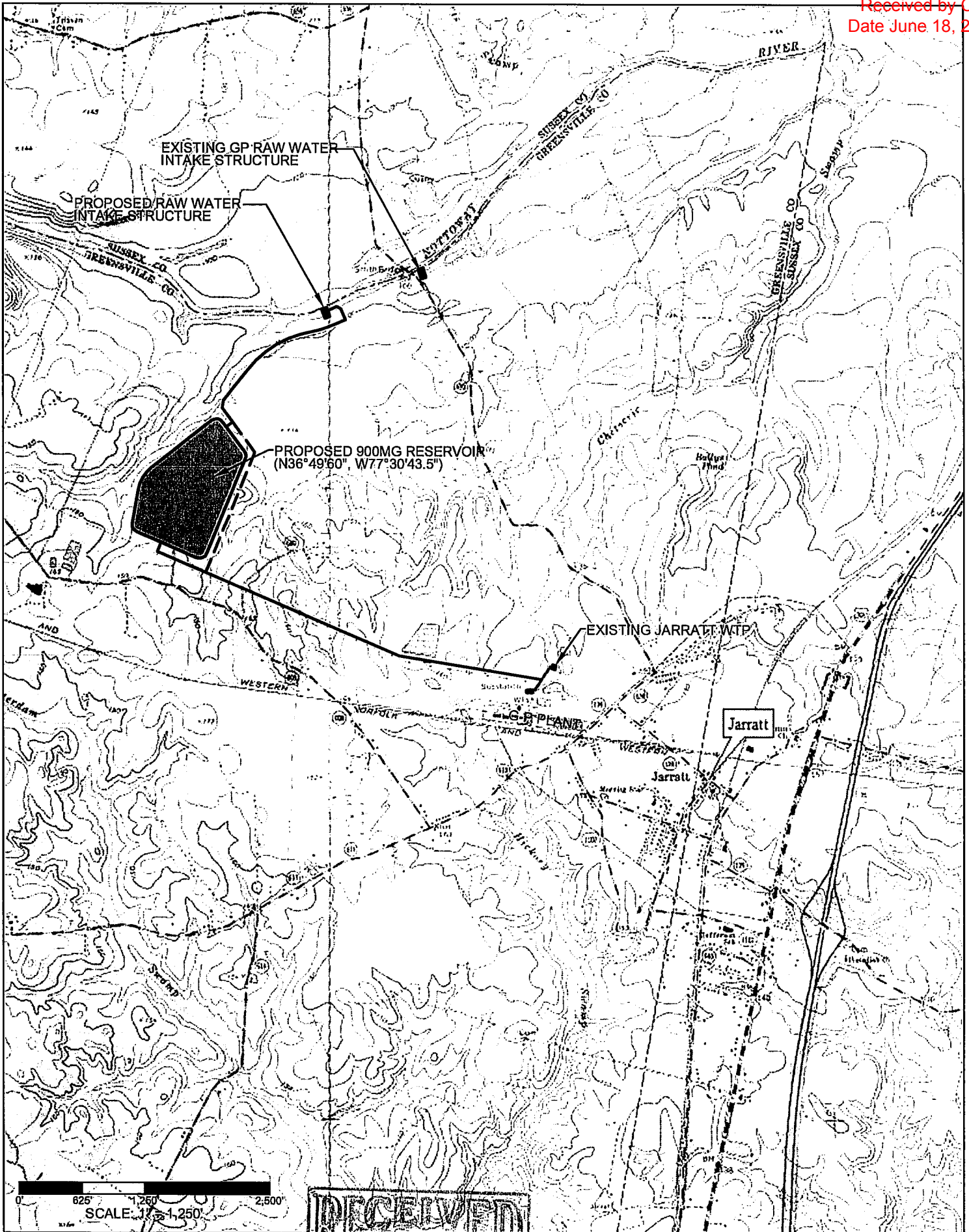

0 625 1250 2500  
SCALE: 1" = 1,250'

RECEIVED  
JUN 18 2013

PREPARED BY:  
**B & B Consultants, Inc.**  
Engineers - Architects - Surveyors  
Planners - Lab Analysts  
South Hill, Chase City, & South Boston, Virginia

MARINE RESOURCES  
COMMISSION

VICINITY MAP  
GREENSVILLE COUNTY  
RAW WATER RESERVOIR & INTAKE

1  
FIGURE

# LEGEND

- PROPOSED WATERLINE
- PROPOSED GRAVEL ACCESS ROAD
- PROPOSED STRUCTURE
- FEMA 100yr FLOOD PLAIN
- WETLANDS
- IMPACTED WETLANDS

**RECEIVED**  
JUN 18 2013  
MARINE RESOURCES  
COMMISSION

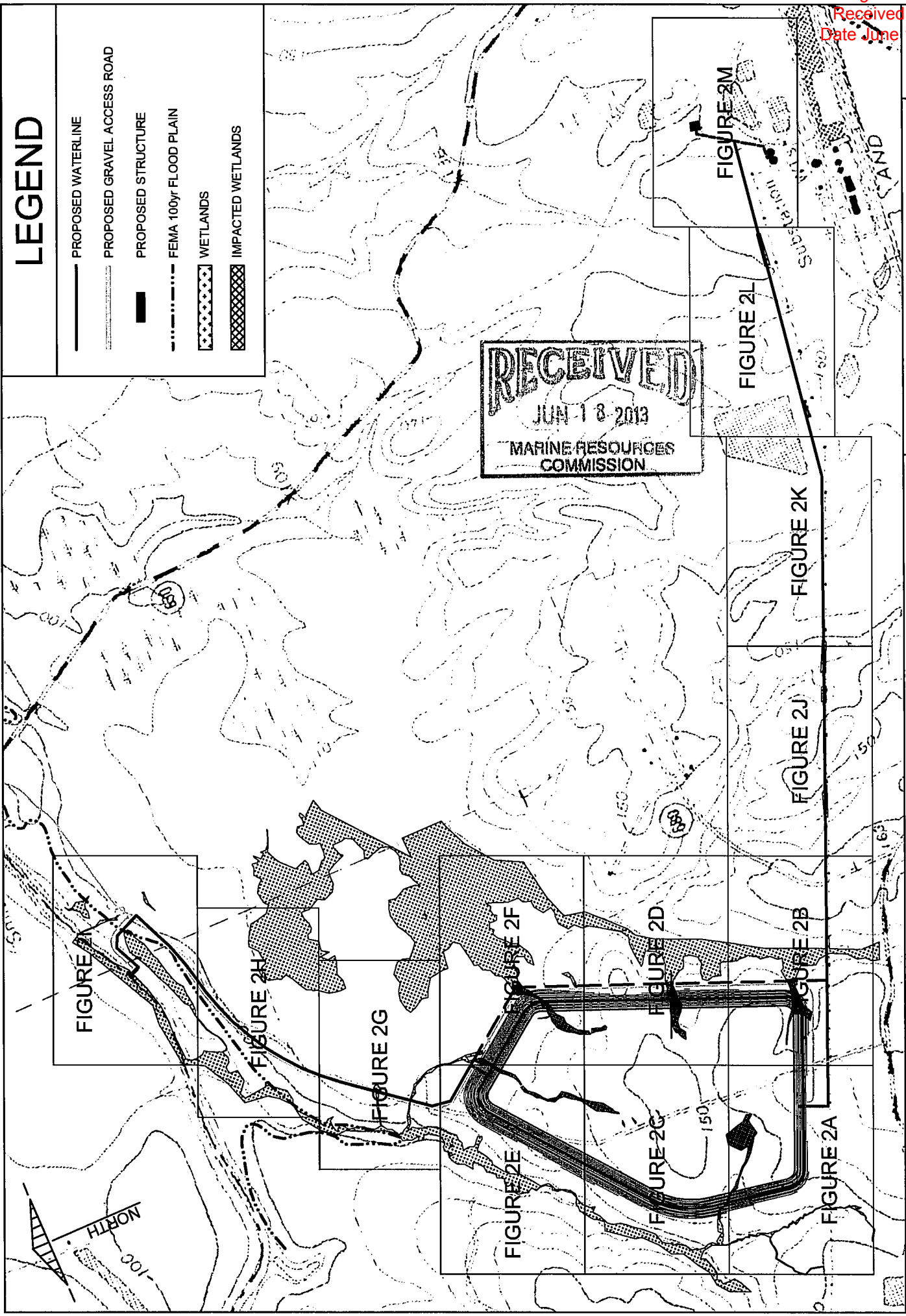

SITE LOCATION & TOPOGRAPHY MAP  
GREENSVILLE COUNTY  
RAW WATER RESERVOIR & INTAKE

0' 625' 1,250' 2,500'  
SCALE: 1" = 1,250'

PREPARED BY:  
**B & B Consultants, Inc.**  
Engineers - Architects - Surveyors  
Planners - Lab Analysts  
South Hill, Chase Ctr. & South Boston, Virginia



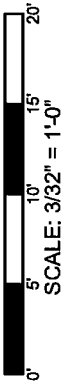
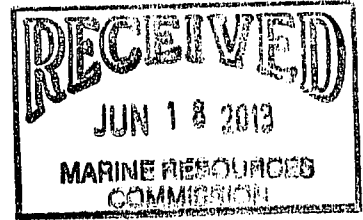
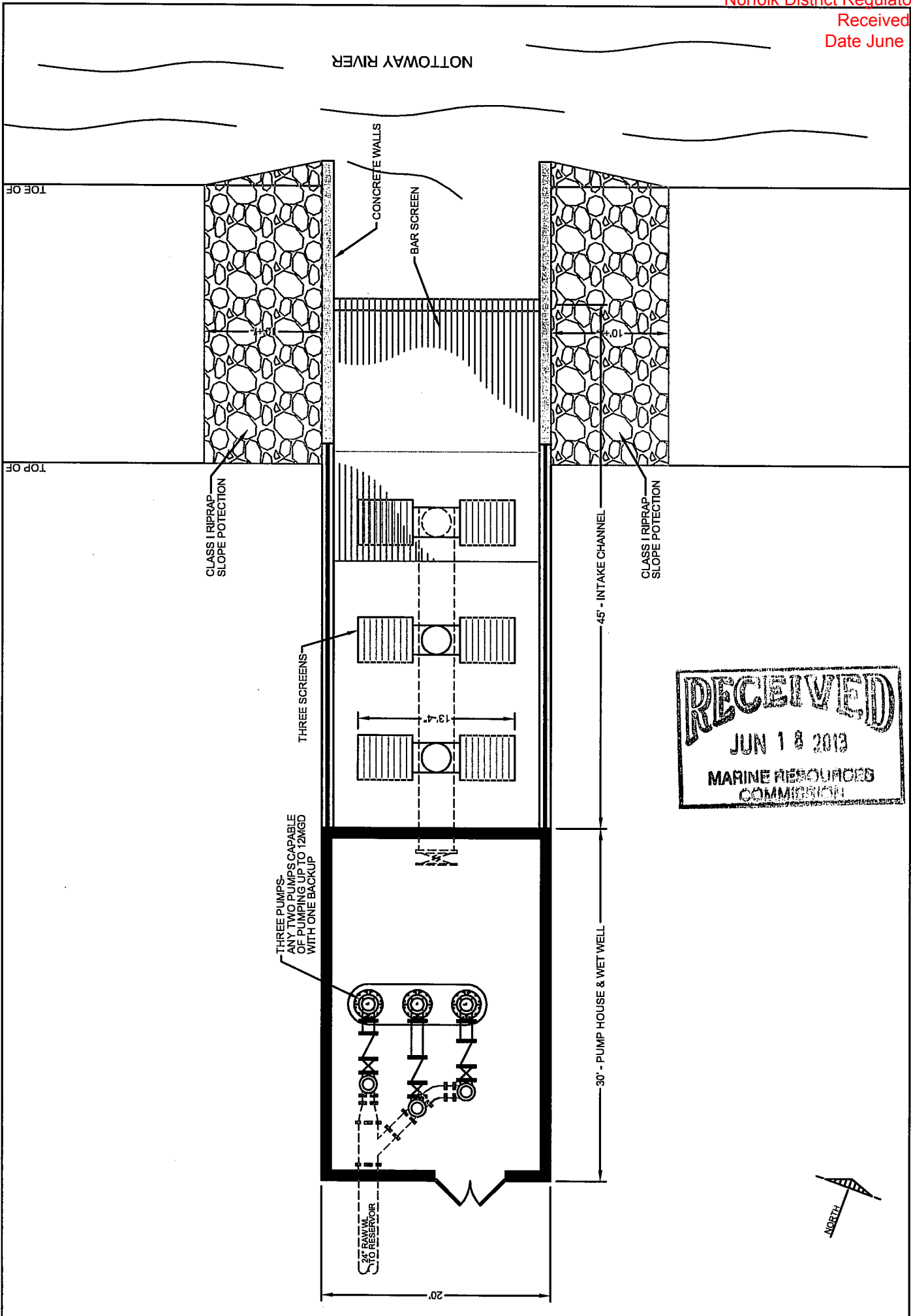

**RECEIVED**  
JUN 18 2013  
MARINE RESOURCES  
COMMISSION

30  
FIGURE

RIVER INTAKE - CROSS SECTION  
GREENSVILLE COUNTY  
RAW WATER RESERVOIR & INTAKE

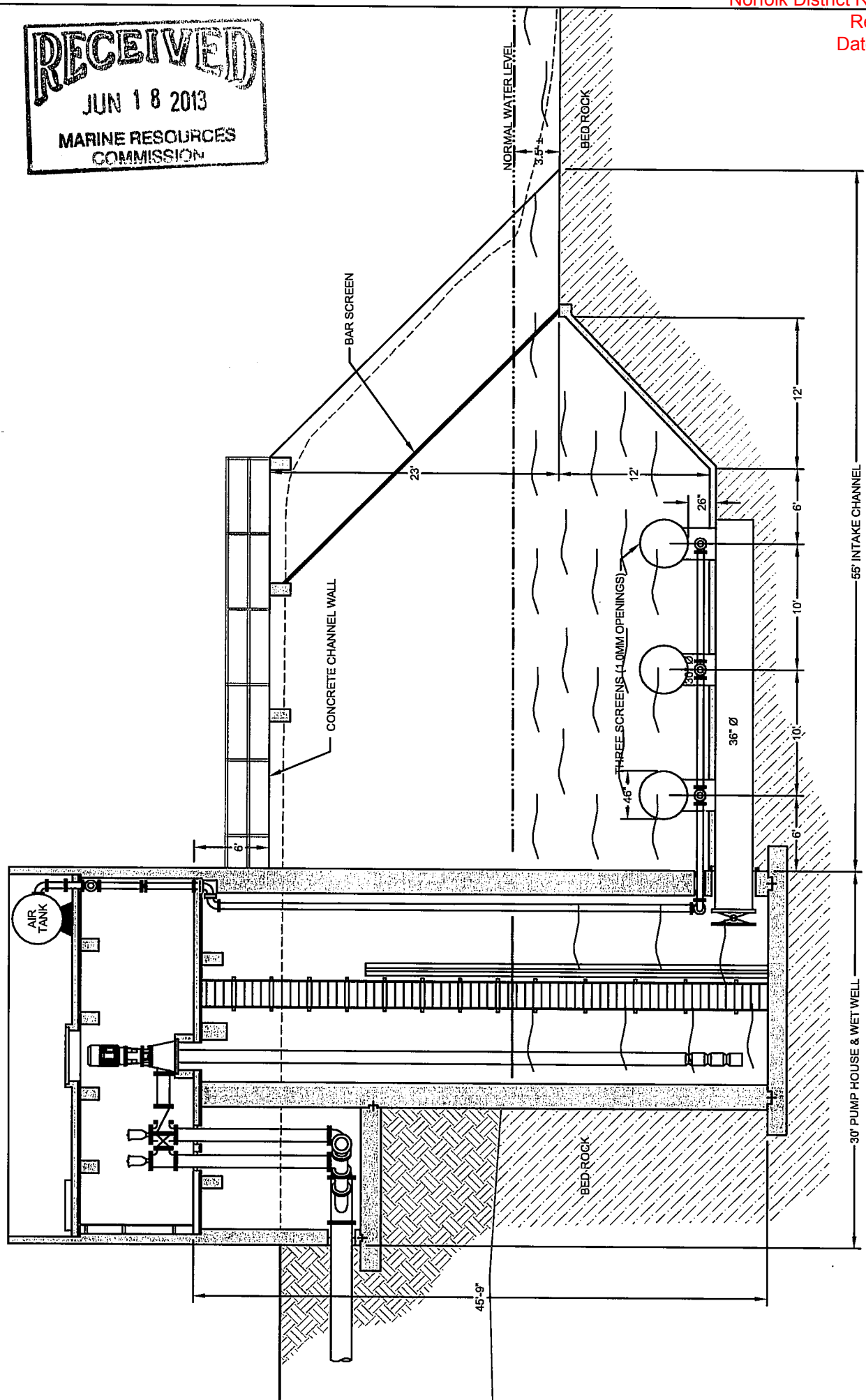
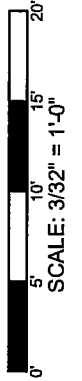



**RECEIVED**  
JUN 18 2013  
MARINE RESOURCES  
COMMISSION

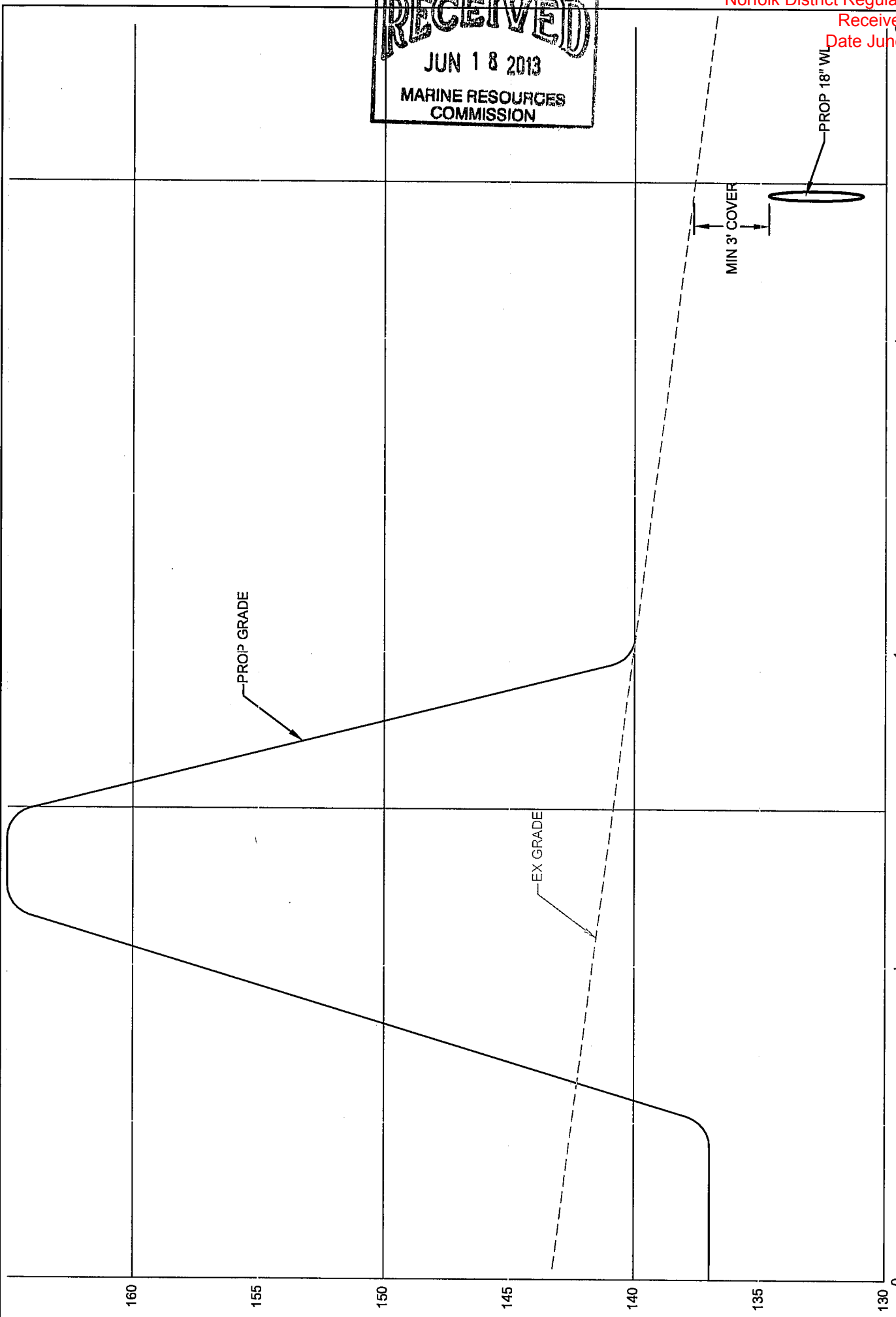

2D-1  
FIC/IRPF  
WETLAND IMPACT #3 PROFILE  
GREENSVILLE COUNTY  
RAW WATER RESERVOIR & INTAKE

PROFILE VIEW- SECTION A-A  
HORZ. SCALE: 1" = 20'  
VERT. SCALE: 1" = 5'

PREPARED BY:  
**B & B Consultants, Inc.**  
Engineers - Architects - Surveyors  
Planners - Lab Analysis  
South Hill, Chase Ctr. & South Boston, Virginia

