

Boat Ramps

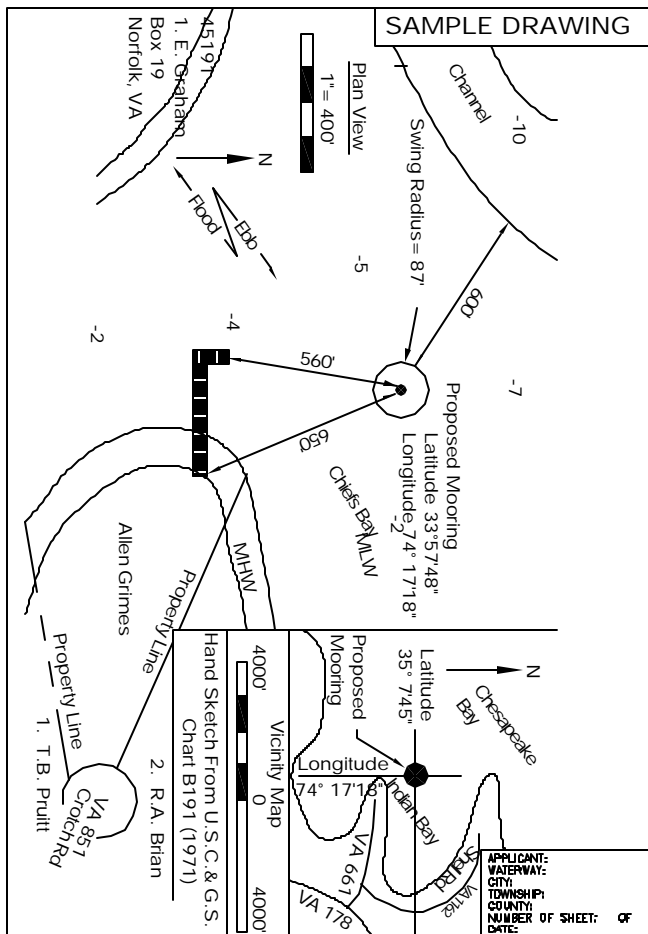

Dolphins or Moorings

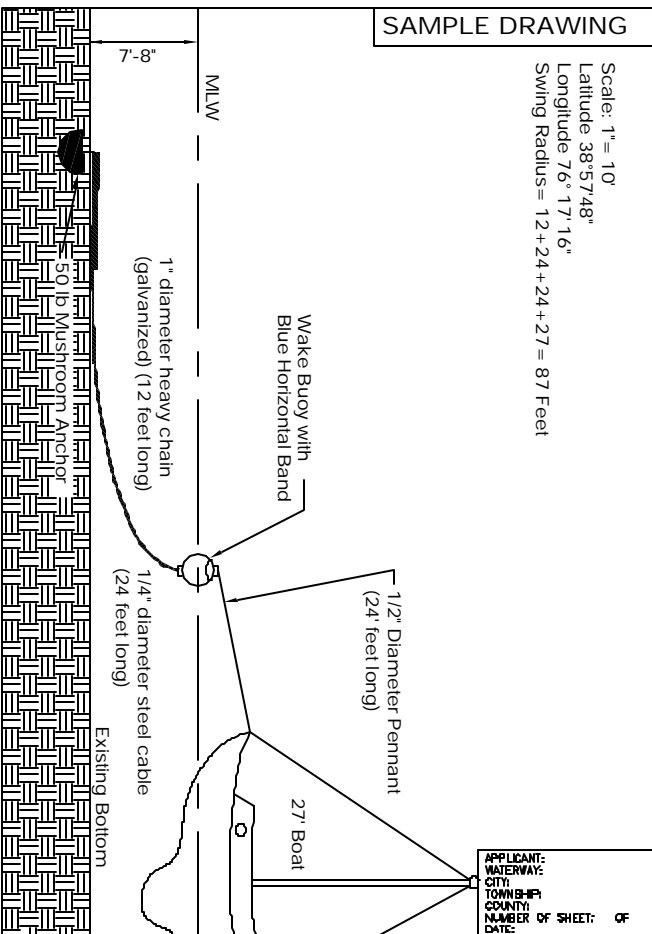
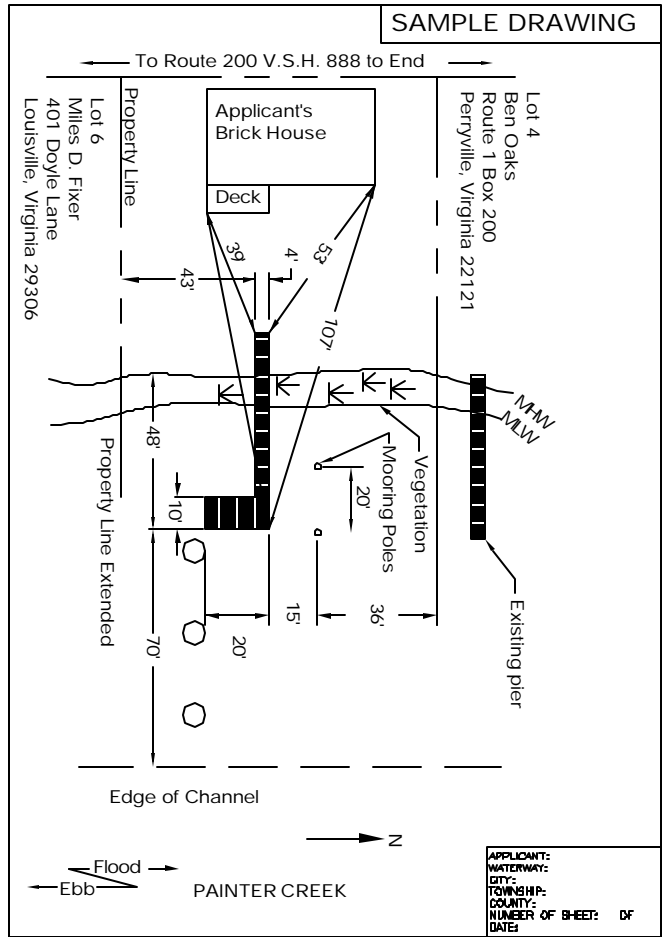
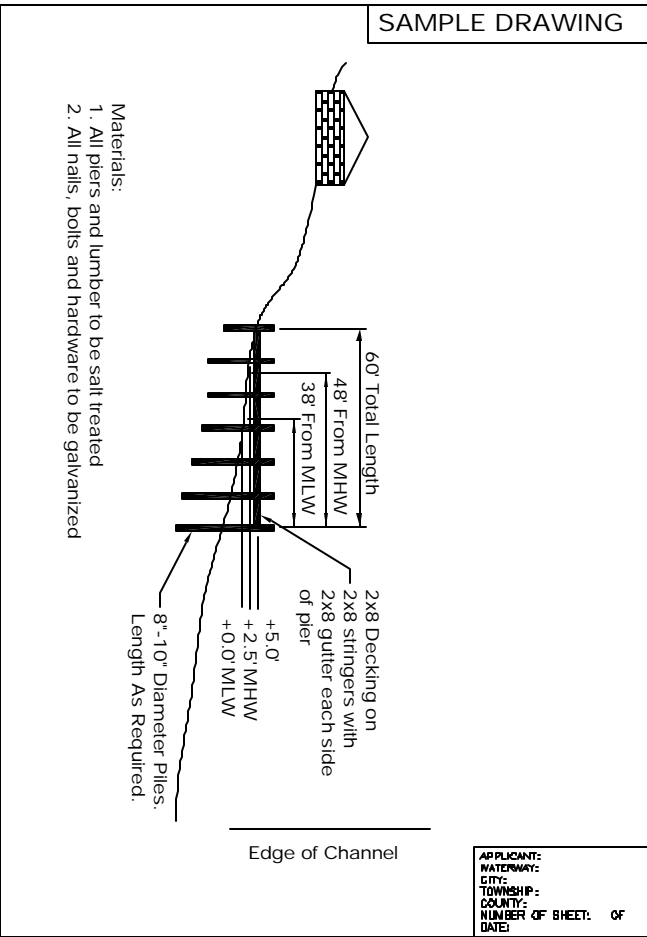

Private Piers & Marginal Wharves

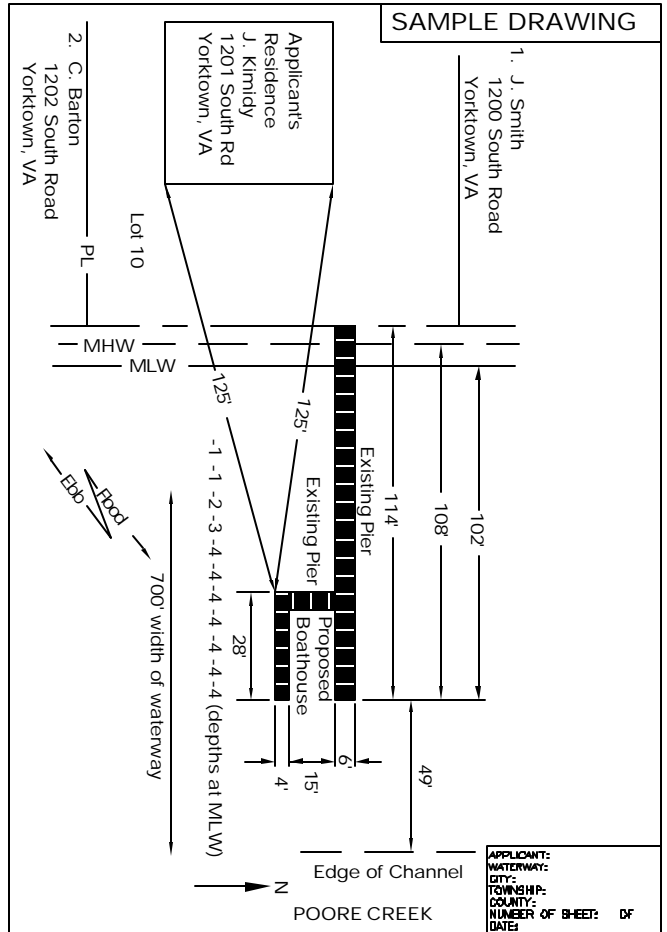
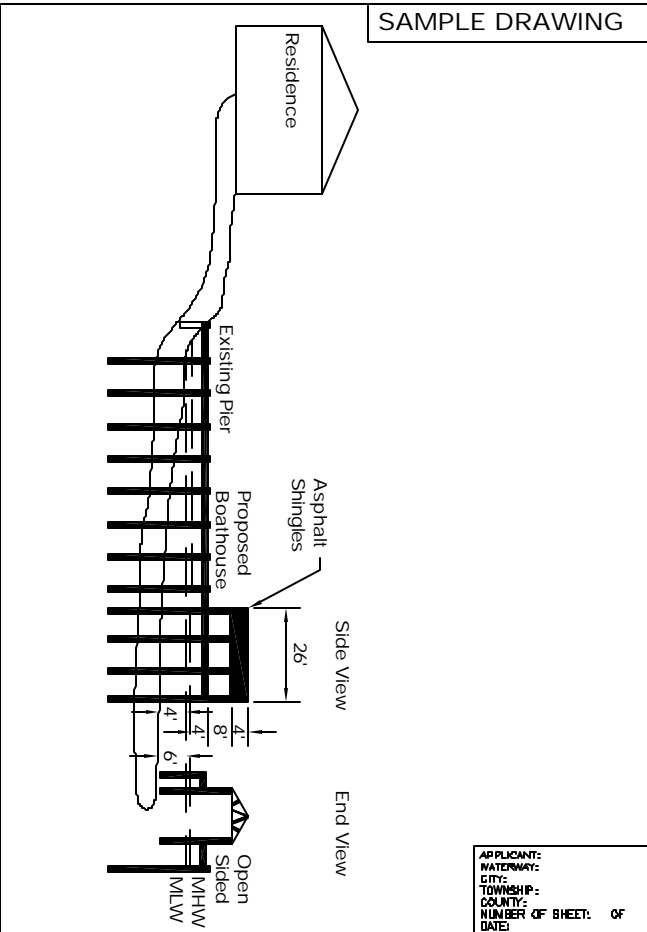

Boathouses

SAMPLE DRAWING

Overall width of waterway is 1800' at Pier 2 and 600' from pier "T" to the channel.

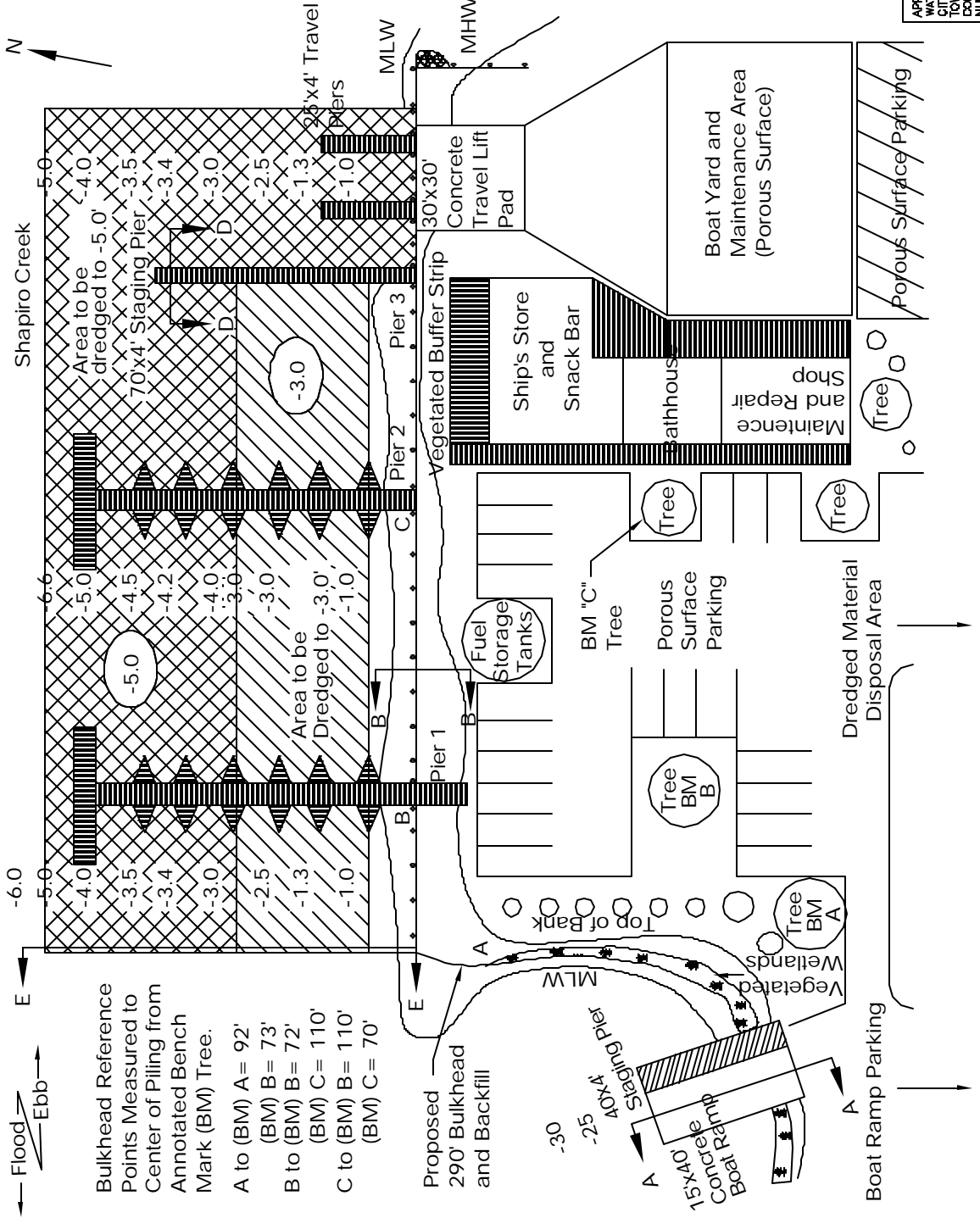

- Bulkhead Reference Points Measured to Center of Piling from Annotated Bench Mark (BM) Tree.
- A to (BM) A = 92'
 - (BM) B = 73'
 - B to (BM) B = 72'
 - (BM) C = 110'
 - C to (BM) B = 110'
 - (BM) C = 70'

APPLICANT: _____
 WATERWAY: _____
 CITY: _____
 TOWNSHIP: _____
 COUNTY: _____
 NUMBER OF SHEET: _____ OF _____
 DATE: _____

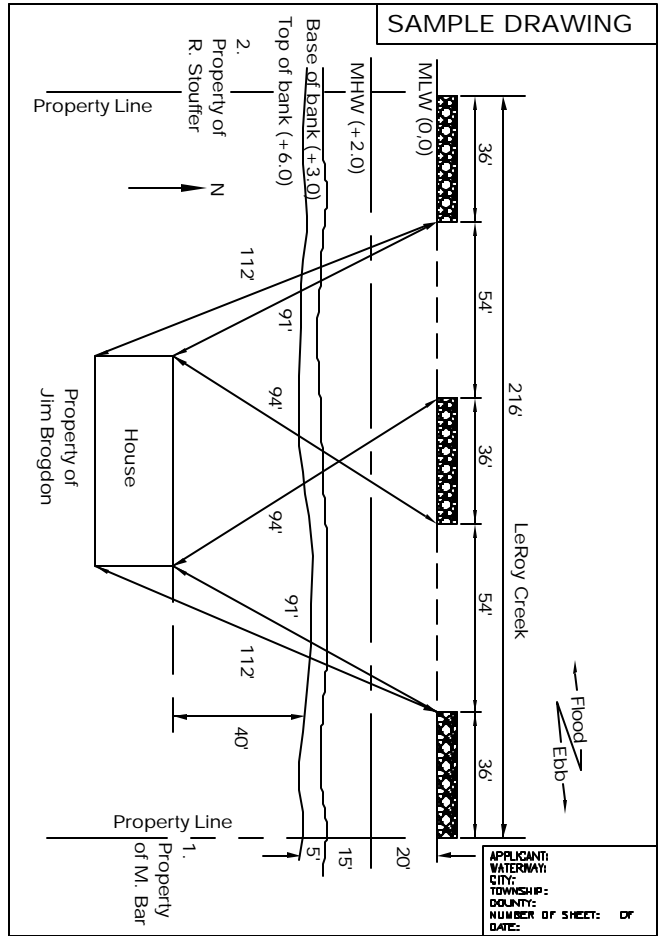

Breakwaters

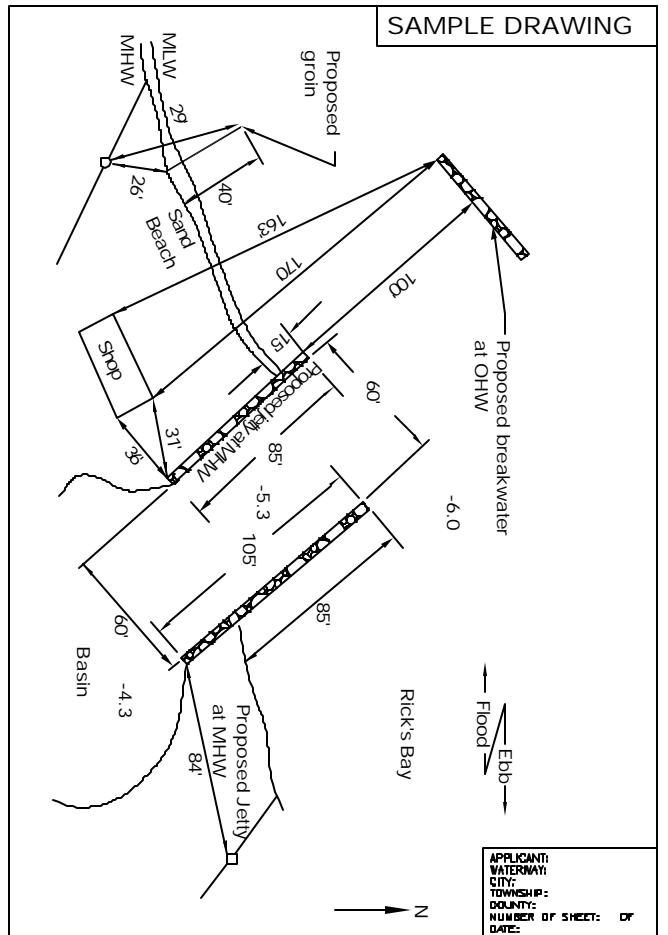
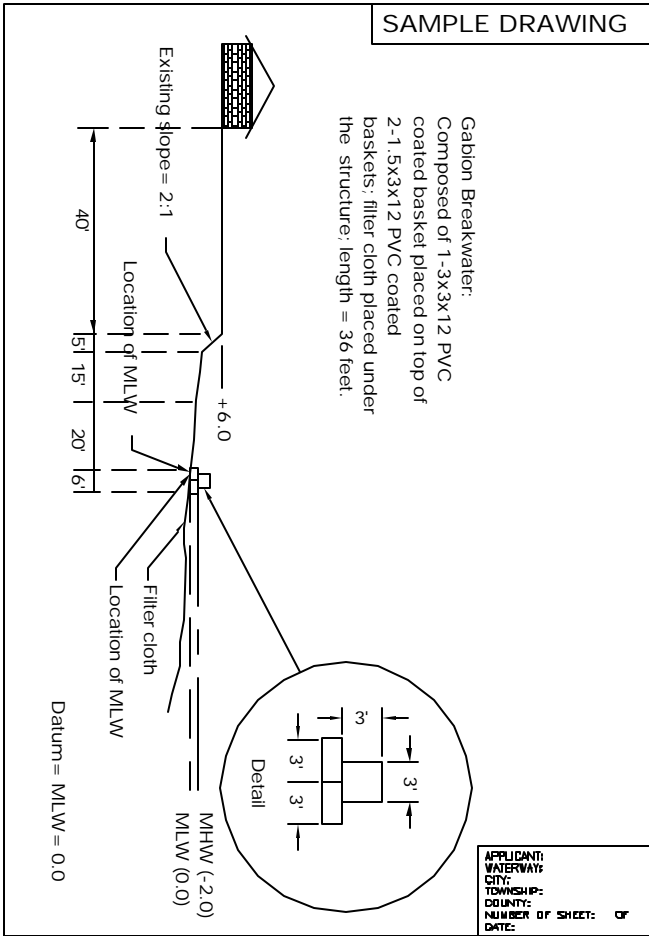

Groins & Jetties

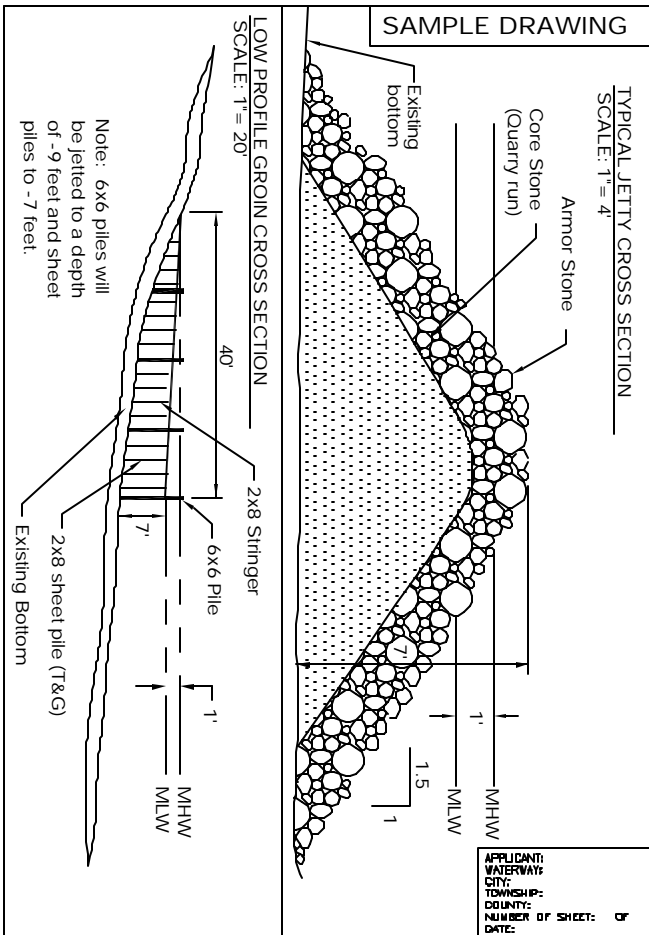

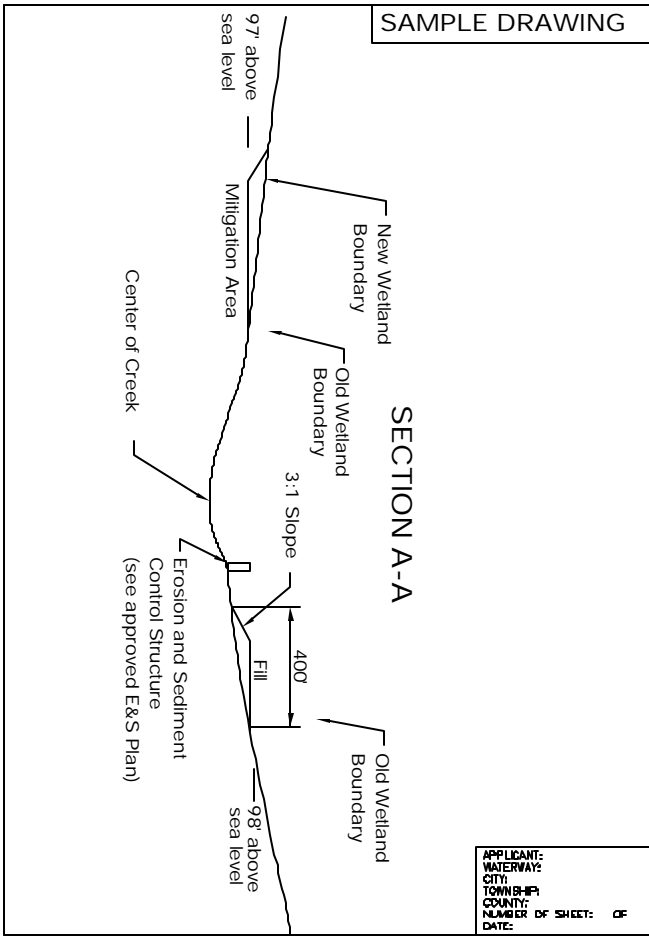
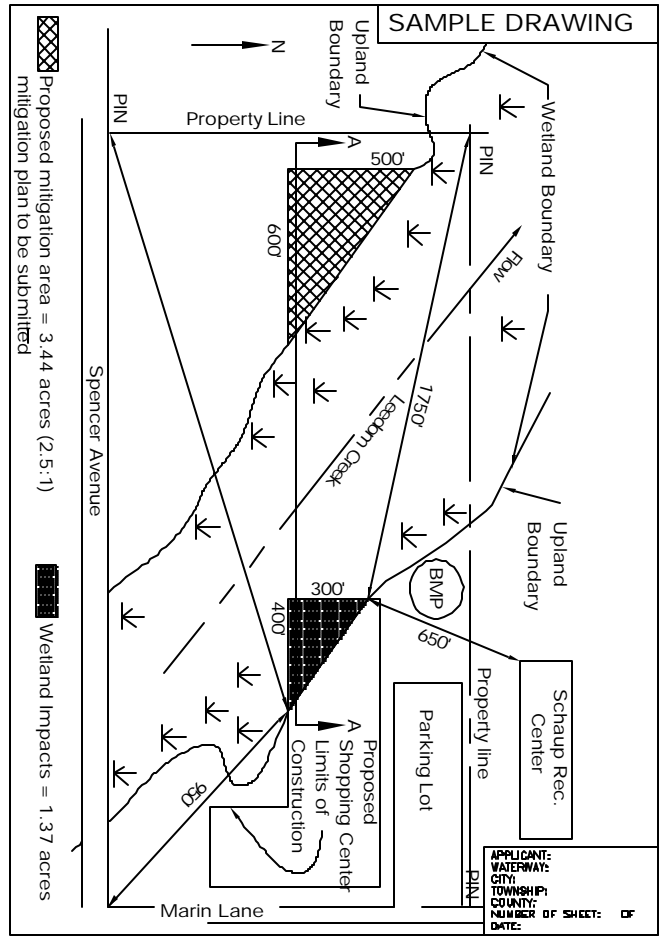

Filling Waters/Wetlands

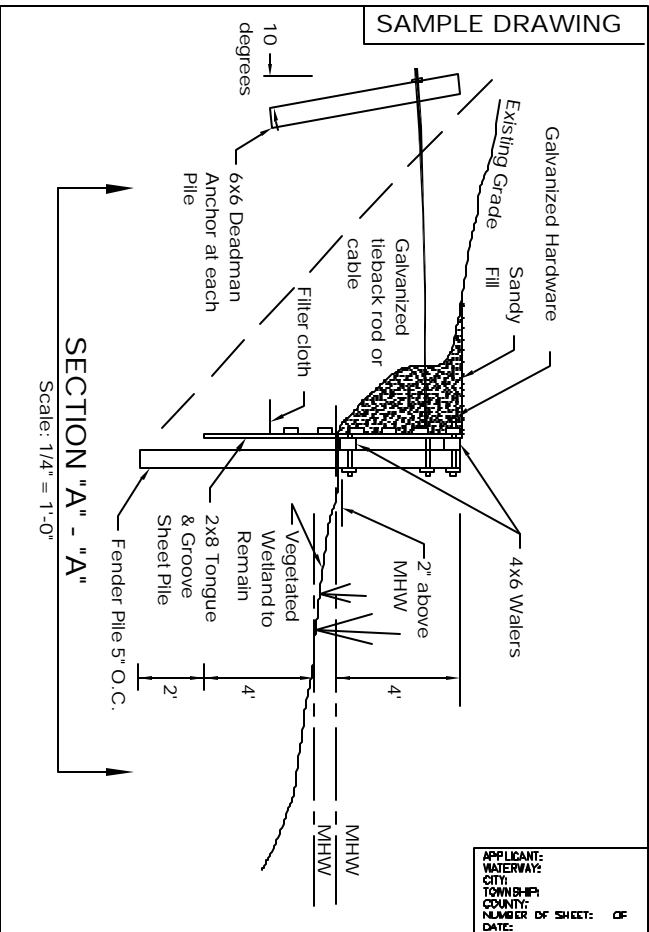
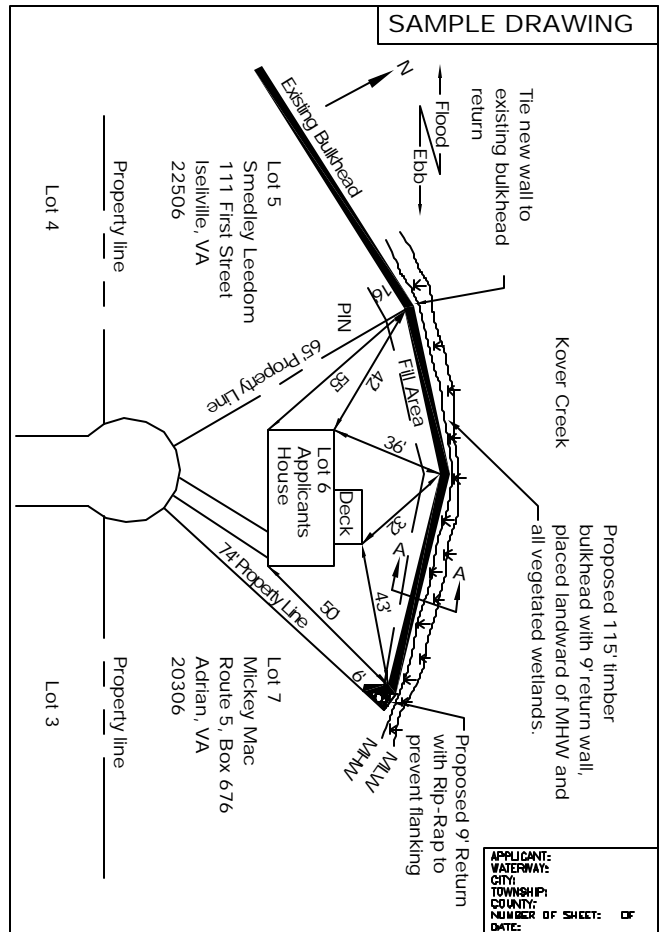

Bulkheads and Associated Backfill

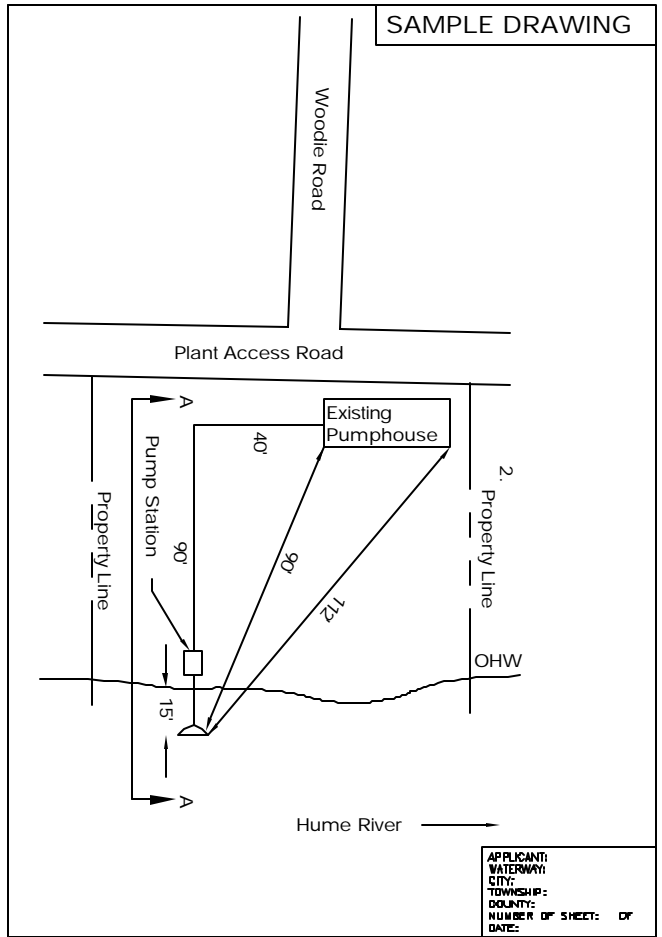
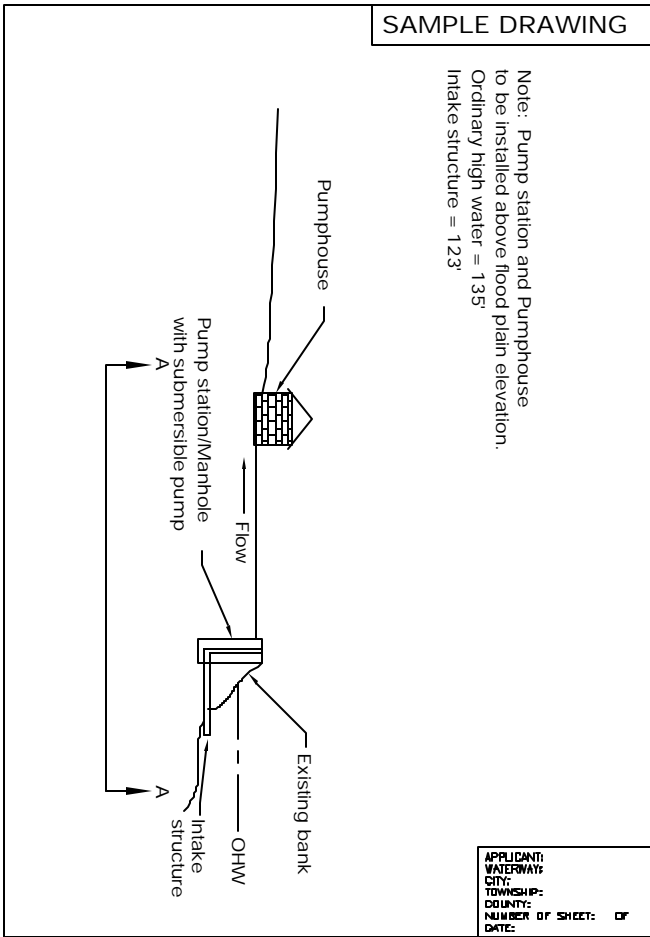

Intake/Outfall Structures

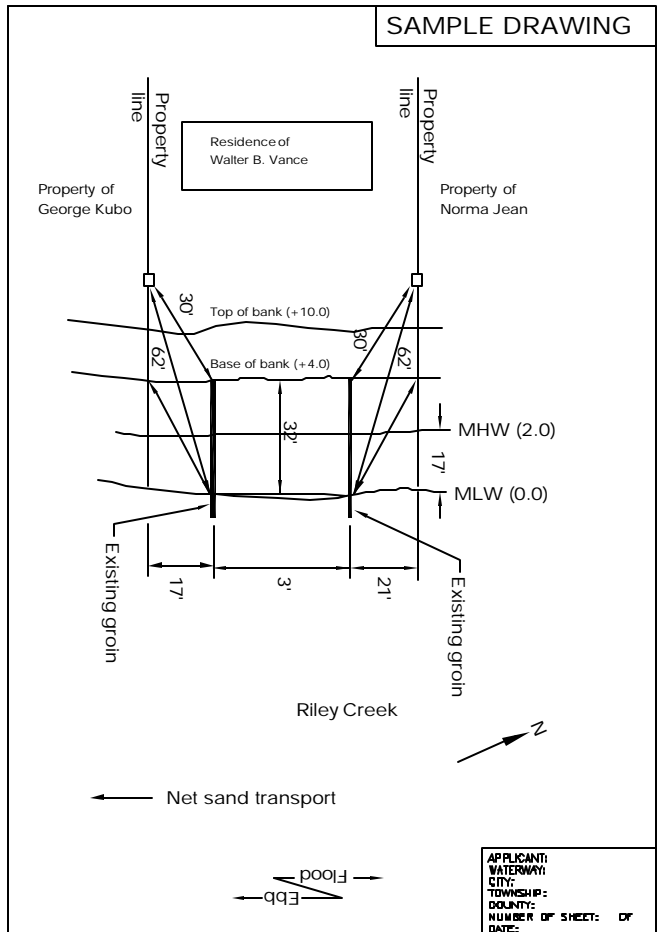
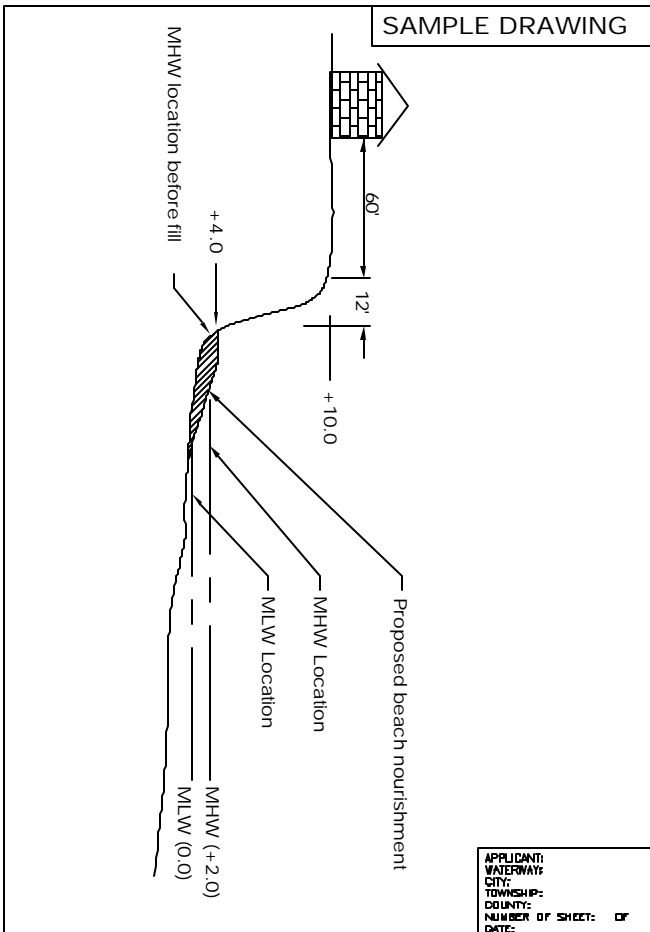

Beach Nourishment

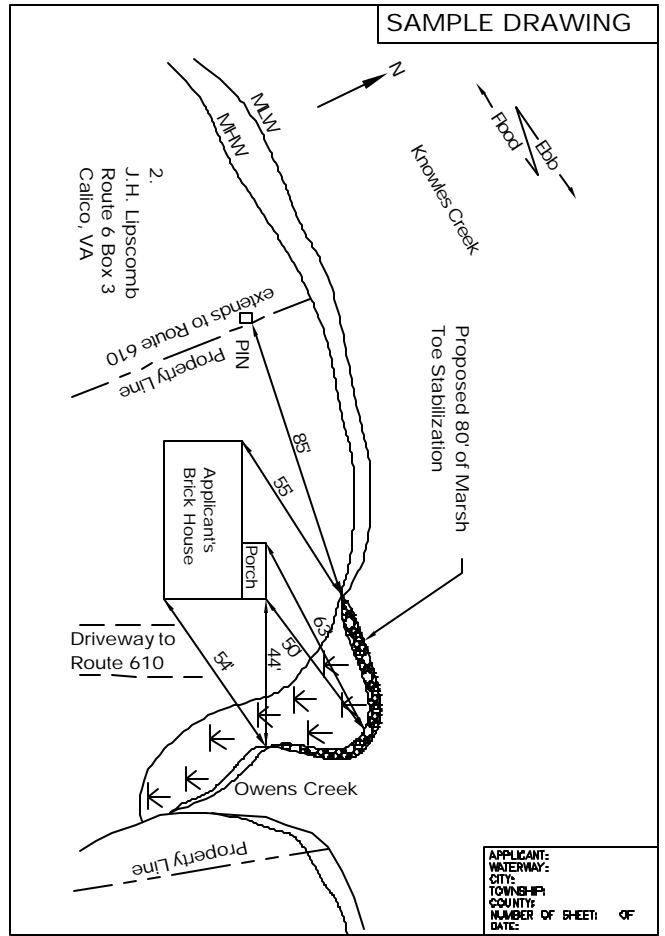
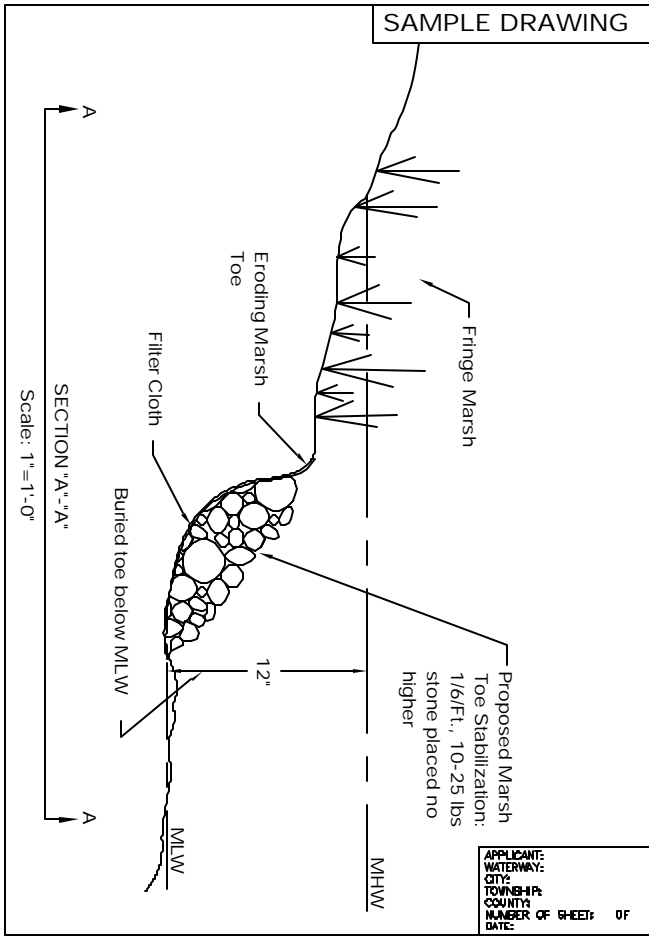

Marsh Toe Stabilization

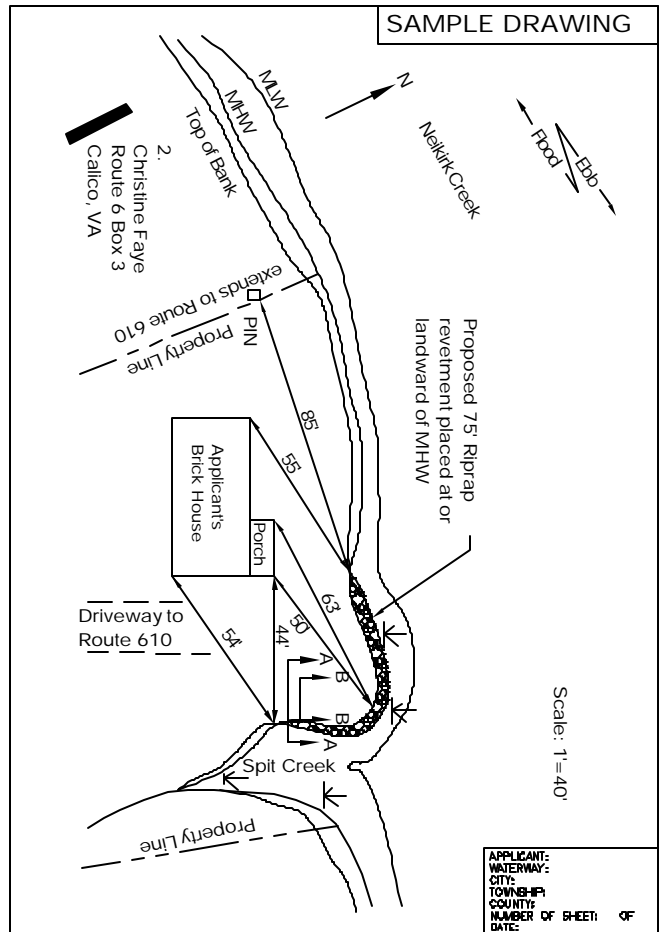
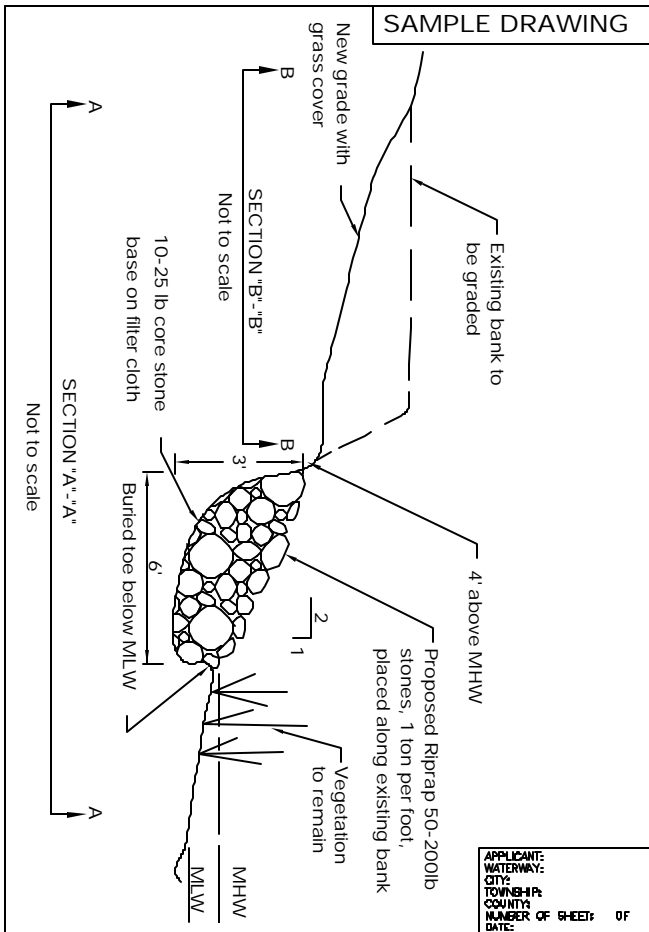

Riprap Revetment & Associated Backfill

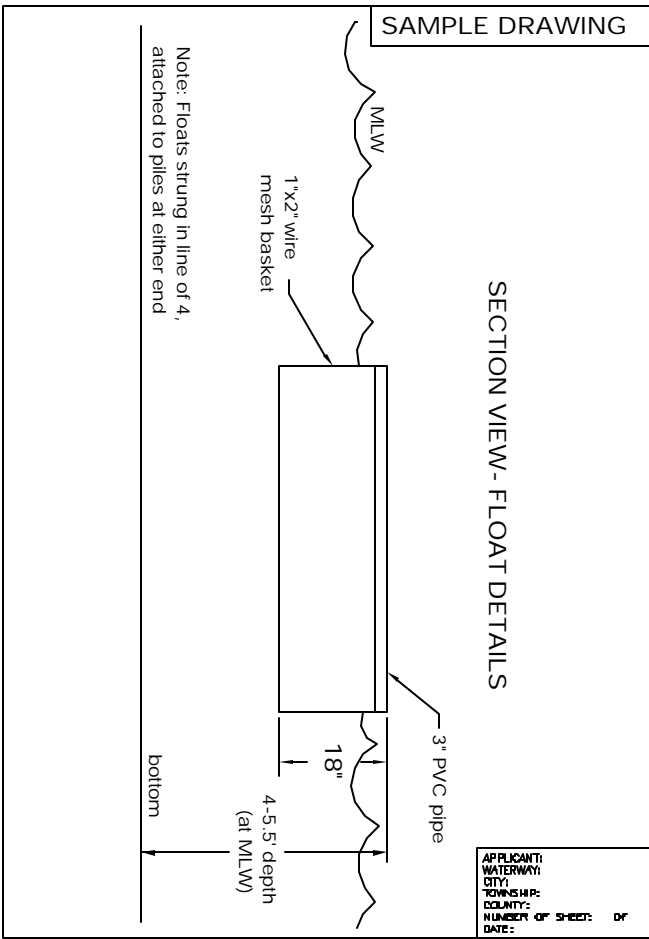
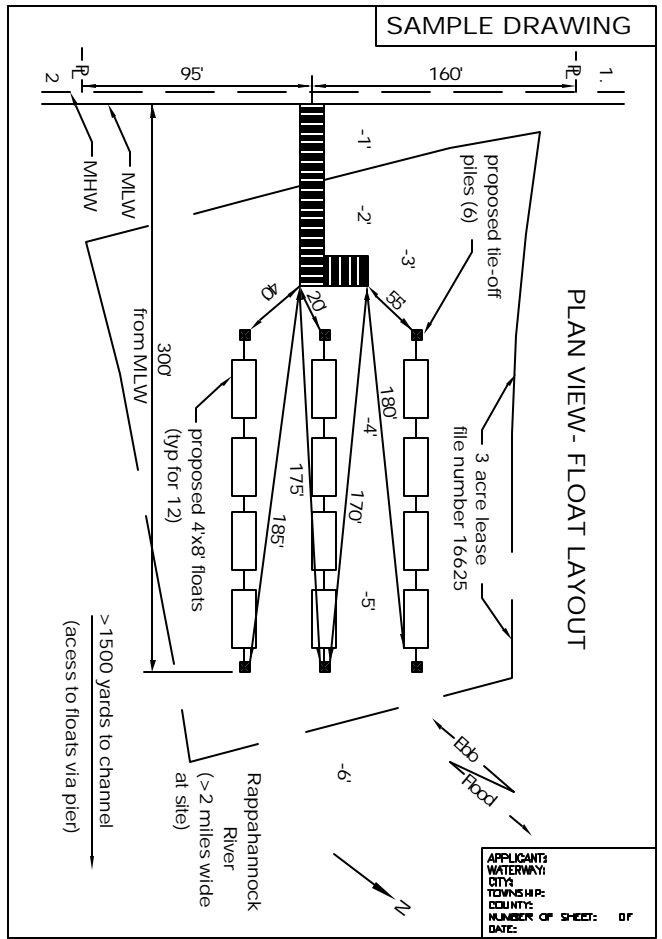

Private & Commercial Aquaculture Activities

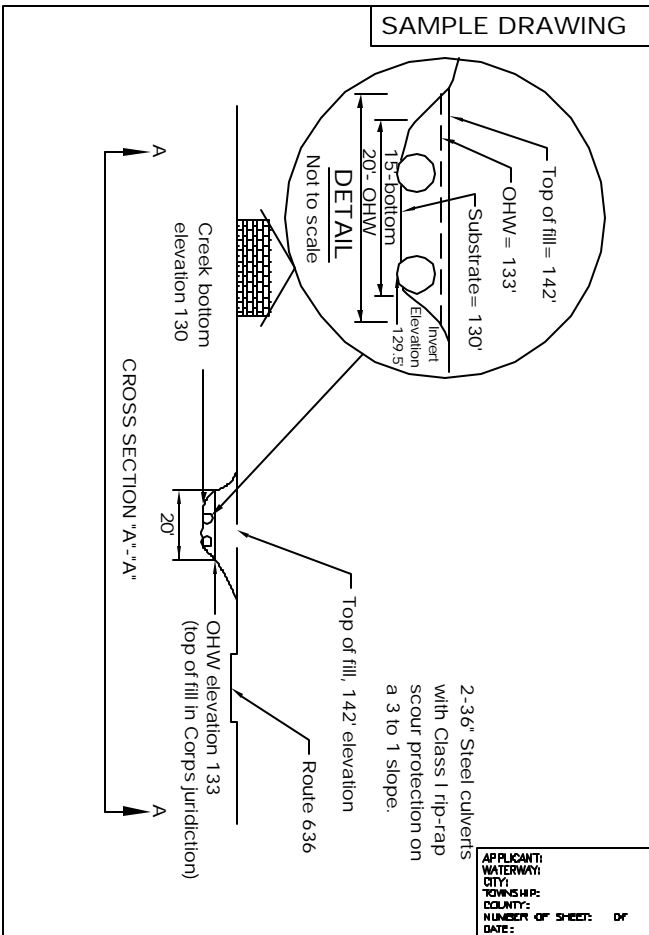
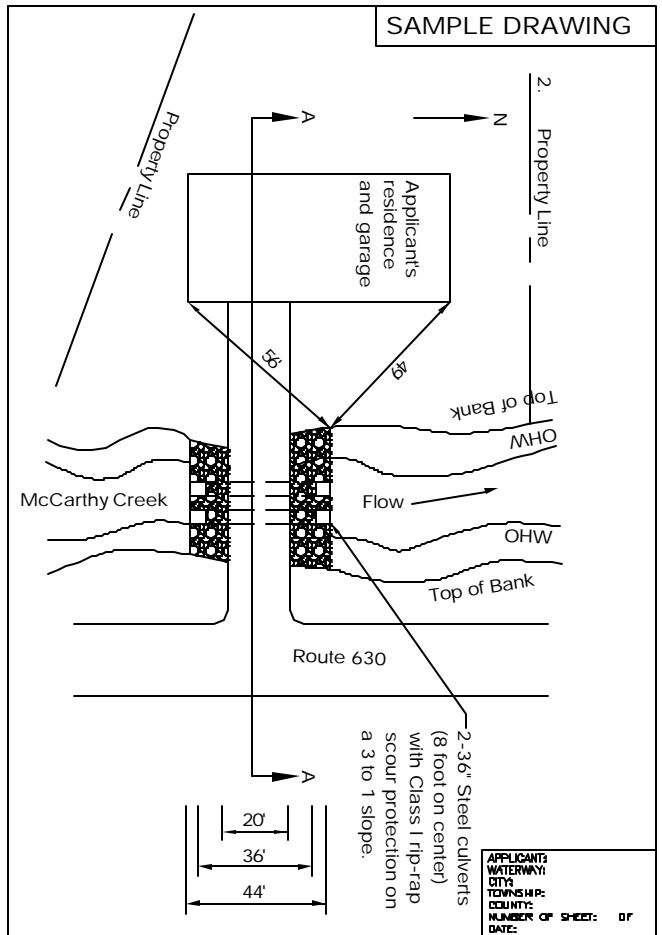

Road Crossings

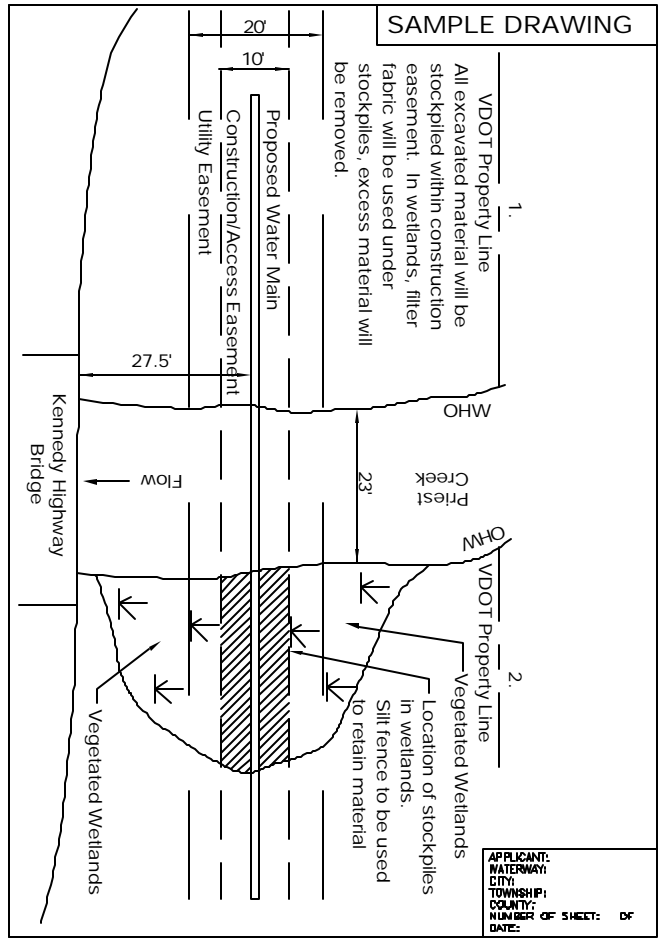
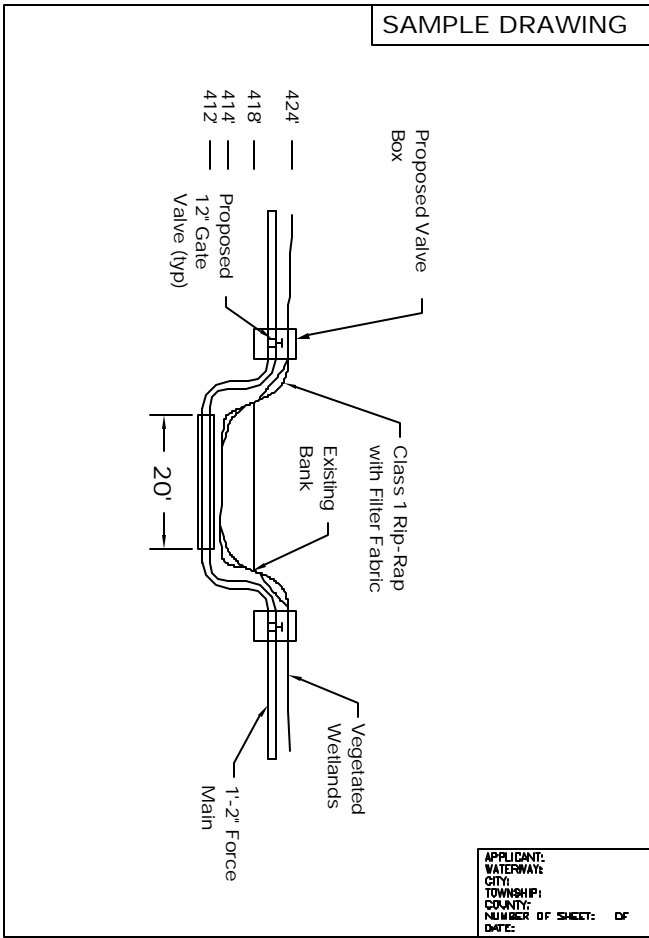

Utility Crossings

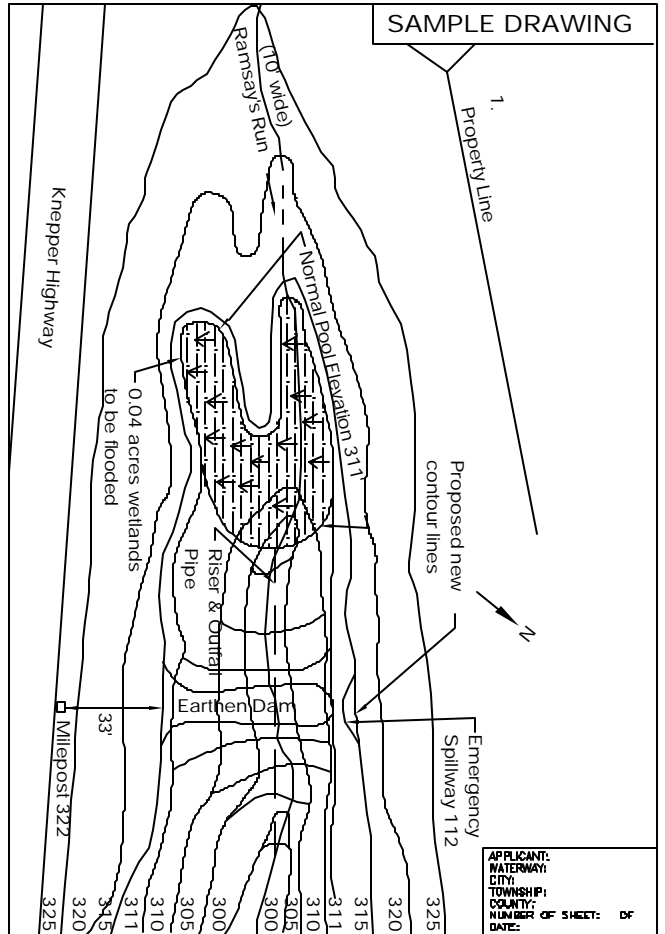
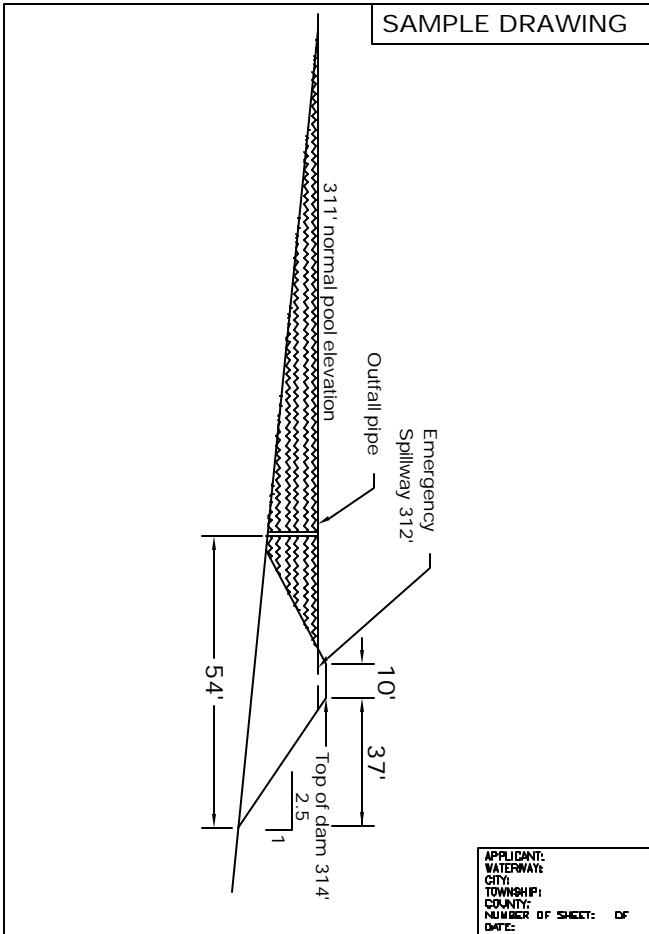

Impoundment/Dams