

Private Piers & Marginal Wharves

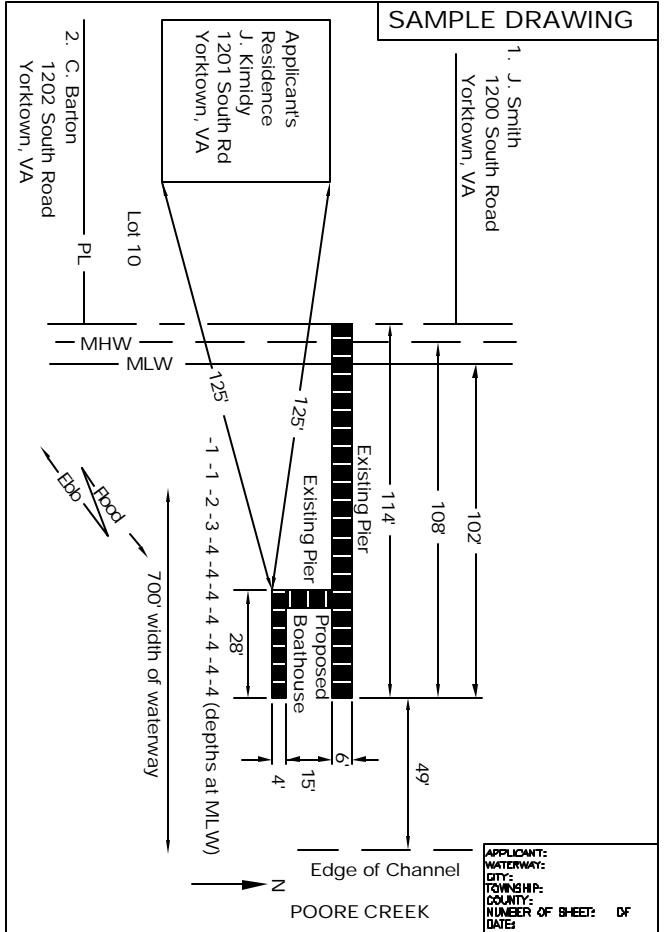
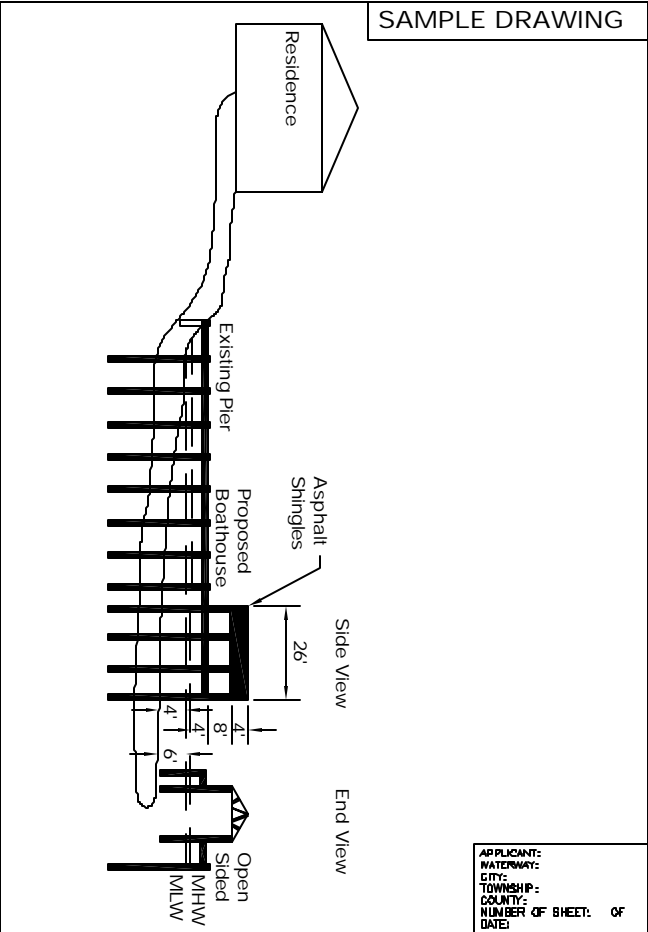

Boathouses

**SAMPLE DRAWING**

Overall width of waterway is 1800' at Pier 2 and 600' from pier "T" to the channel.

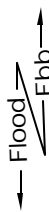
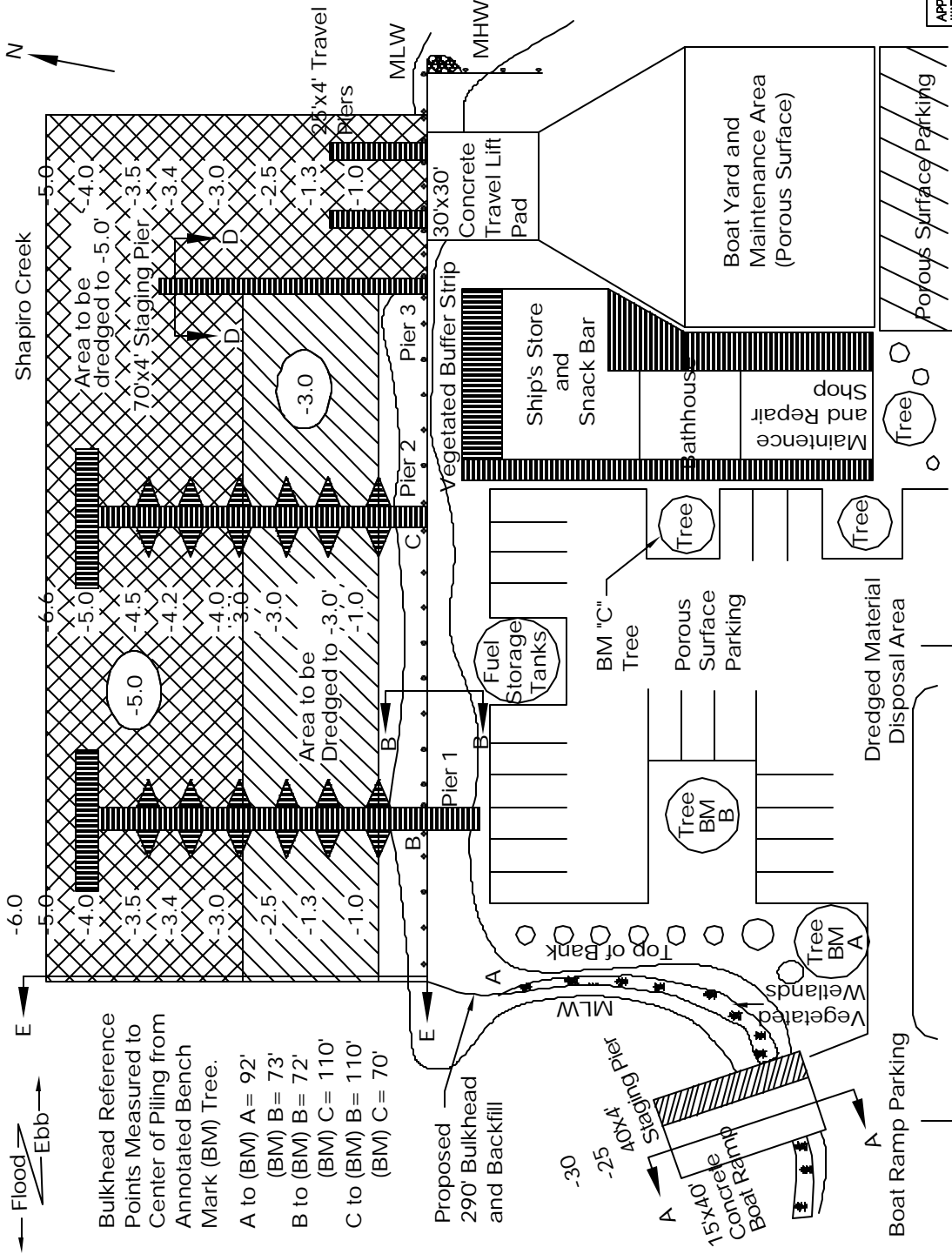

- Bulkhead Reference Points Measured to Center of Piling from Annotated Bench Mark (BM) Tree.
- A to (BM) A = 92'
  - (BM) B = 73'
  - B to (BM) B = 72'
  - (BM) C = 110'
  - C to (BM) B = 110'
  - (BM) C = 70'

APPLICANT: \_\_\_\_\_  
 WATERWAY: \_\_\_\_\_  
 CITY: \_\_\_\_\_  
 TOWNSHIP: \_\_\_\_\_  
 COUNTY: \_\_\_\_\_  
 NUMBER OF SHEET: \_\_\_\_\_ OF \_\_\_\_\_  
 DATE: \_\_\_\_\_

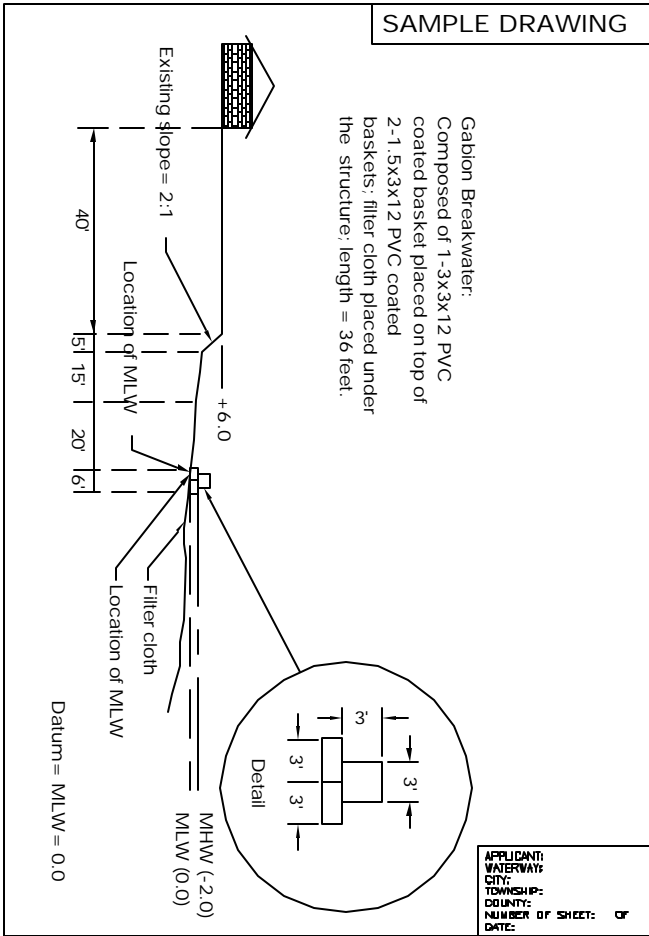
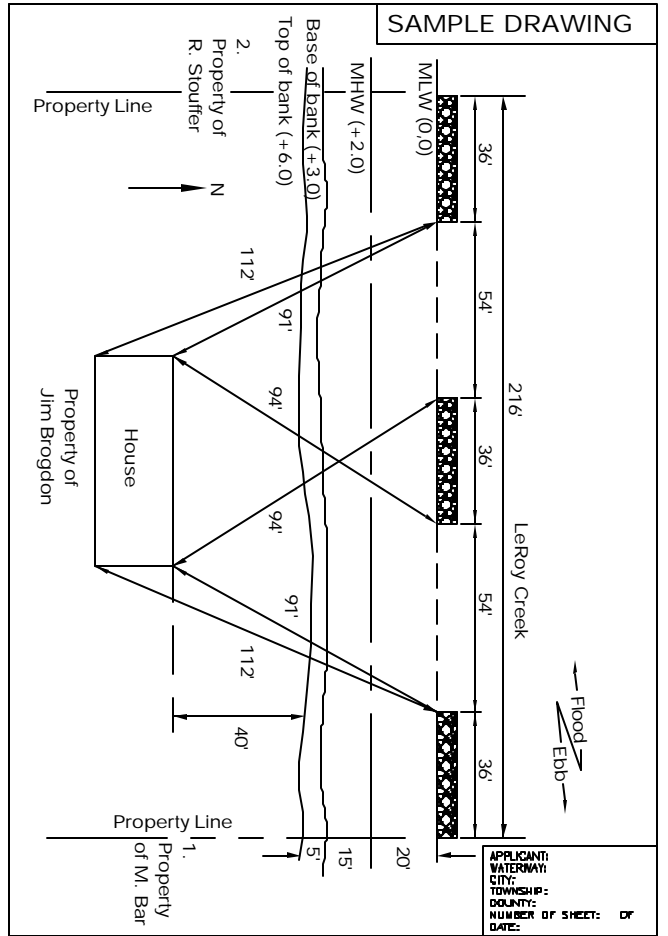

Breakwaters

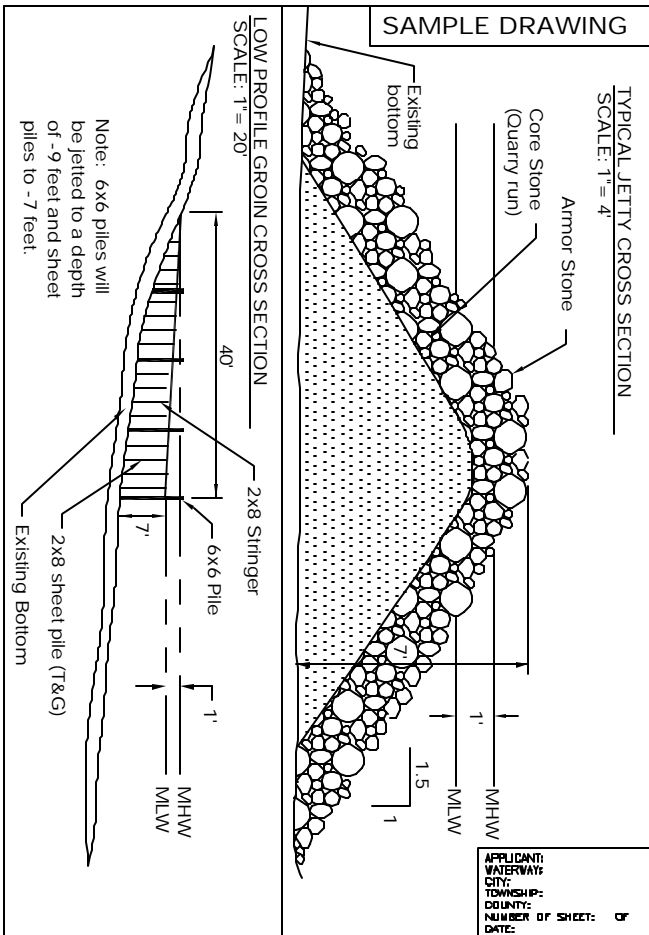
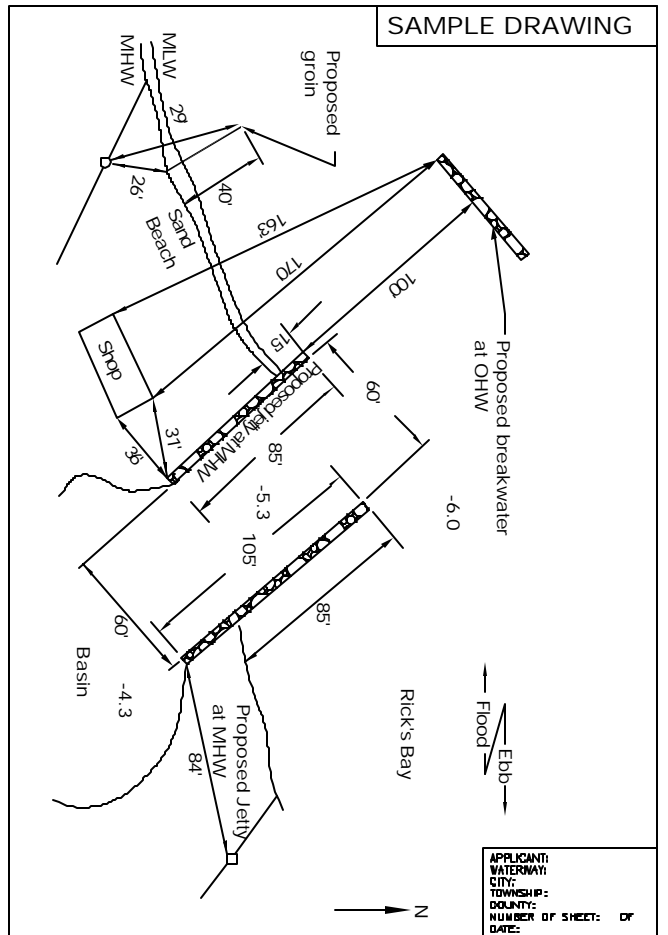

Groins & Jetties

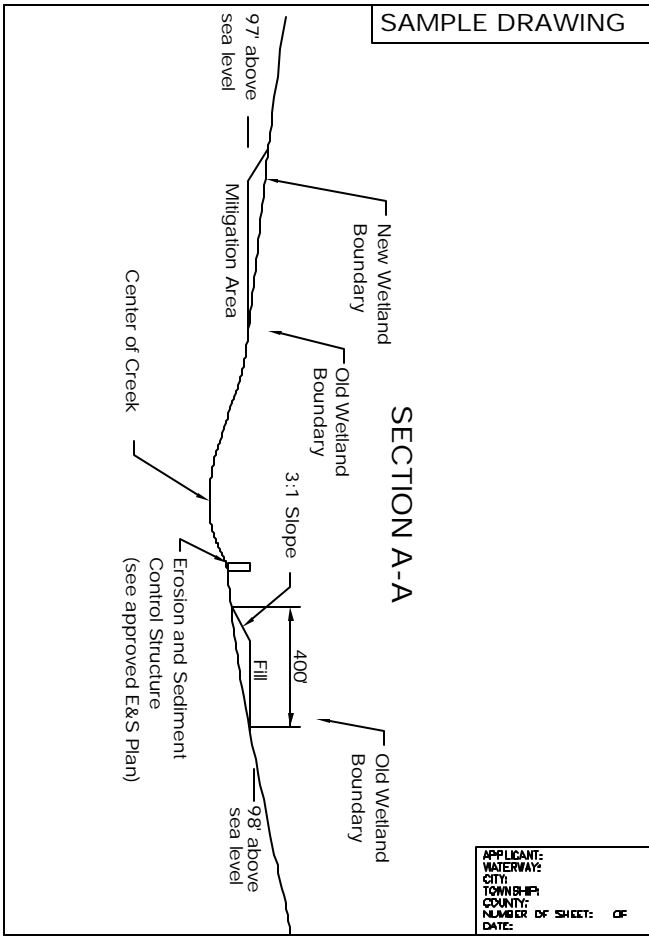
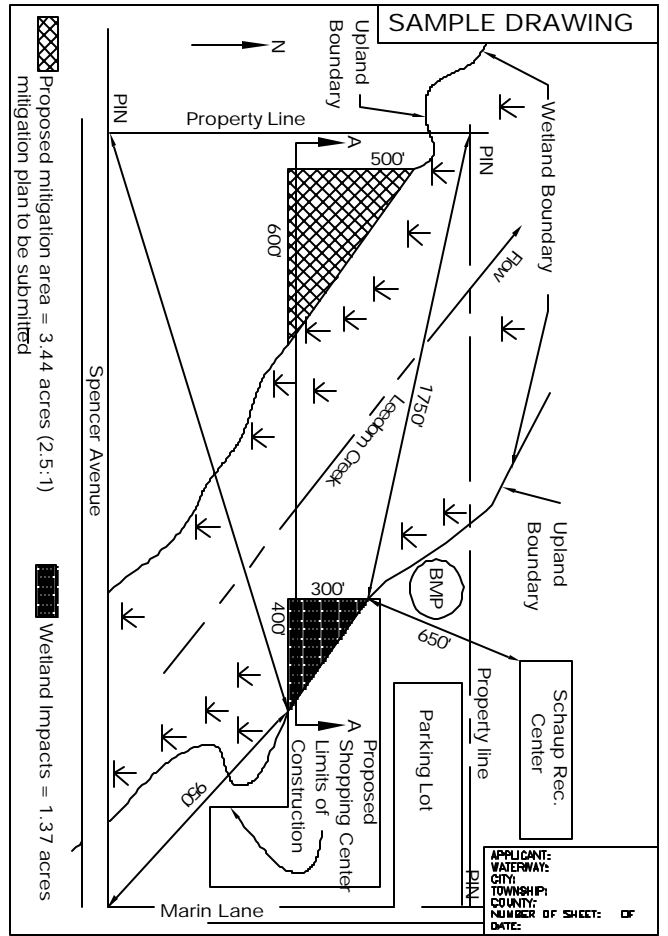

Filling Waters/Wetlands

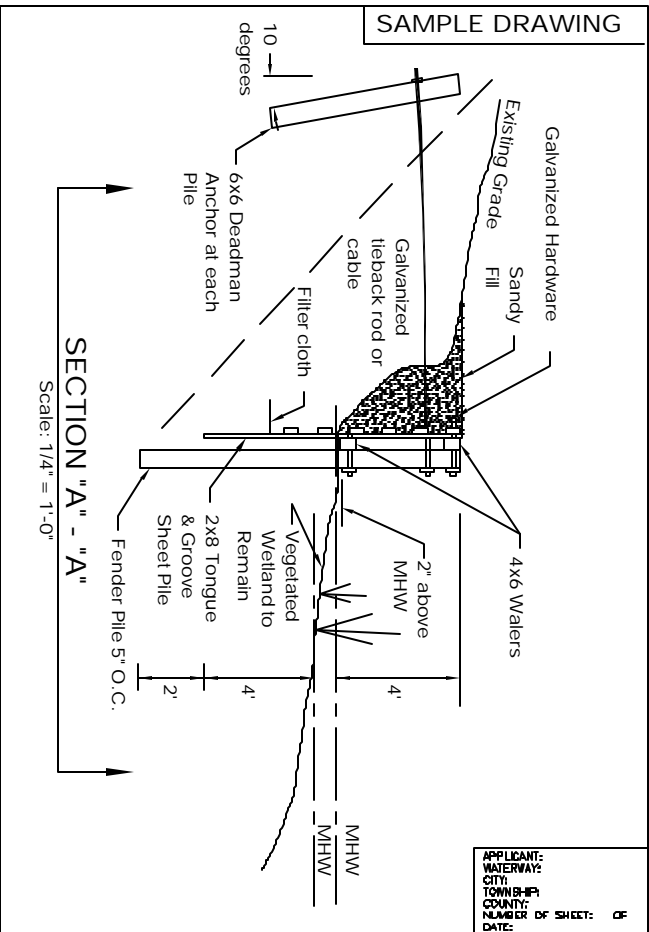
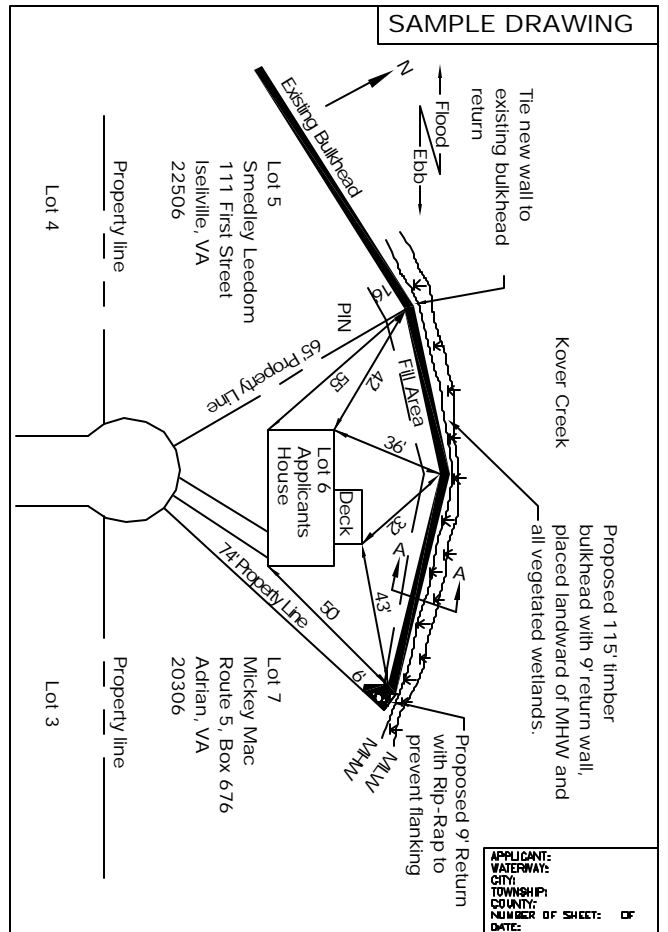

Bulkheads and Associated Backfill





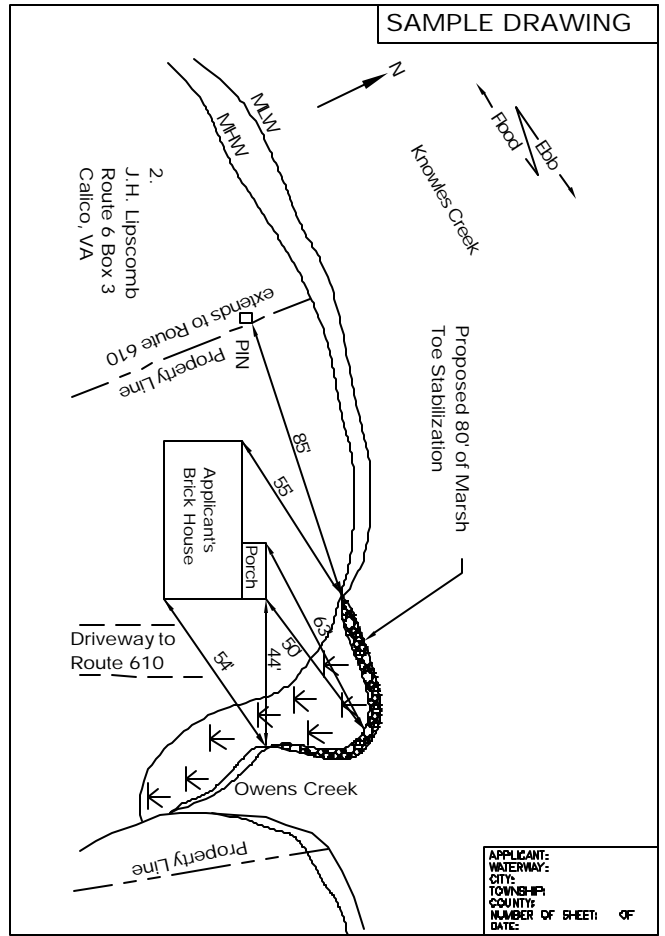
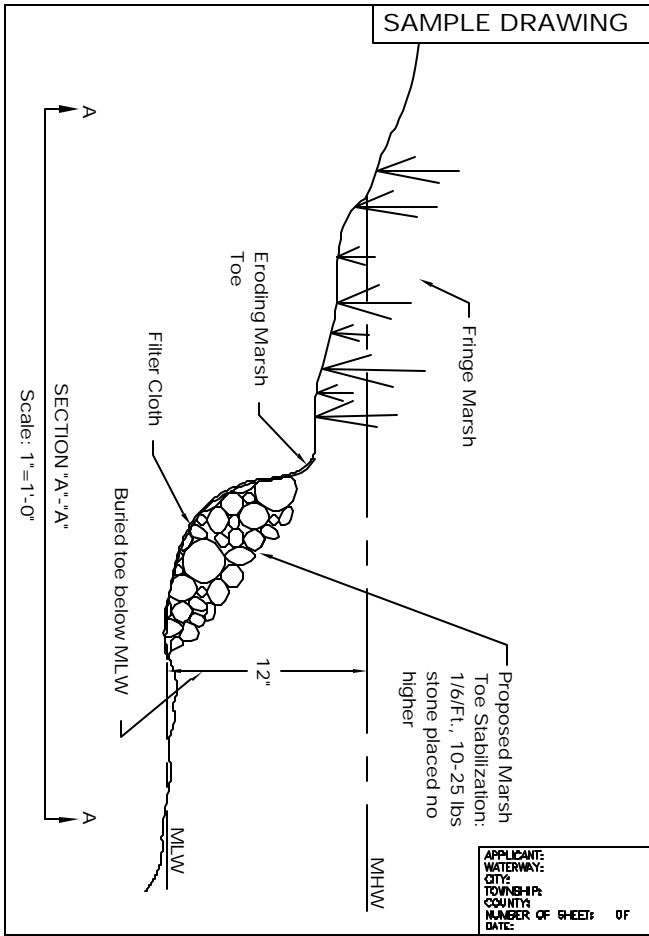

Marsh Toe Stabilization

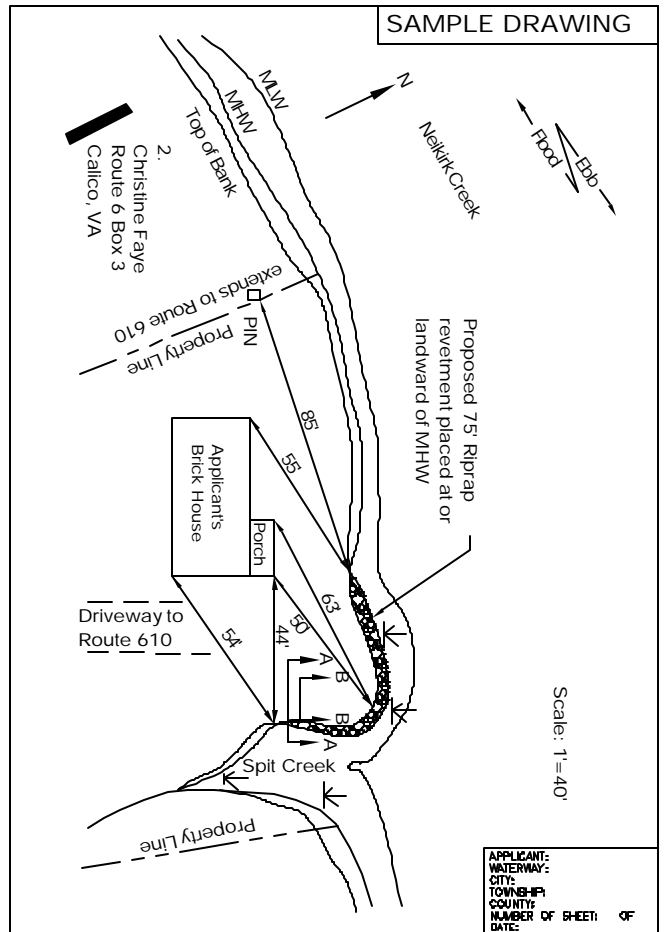
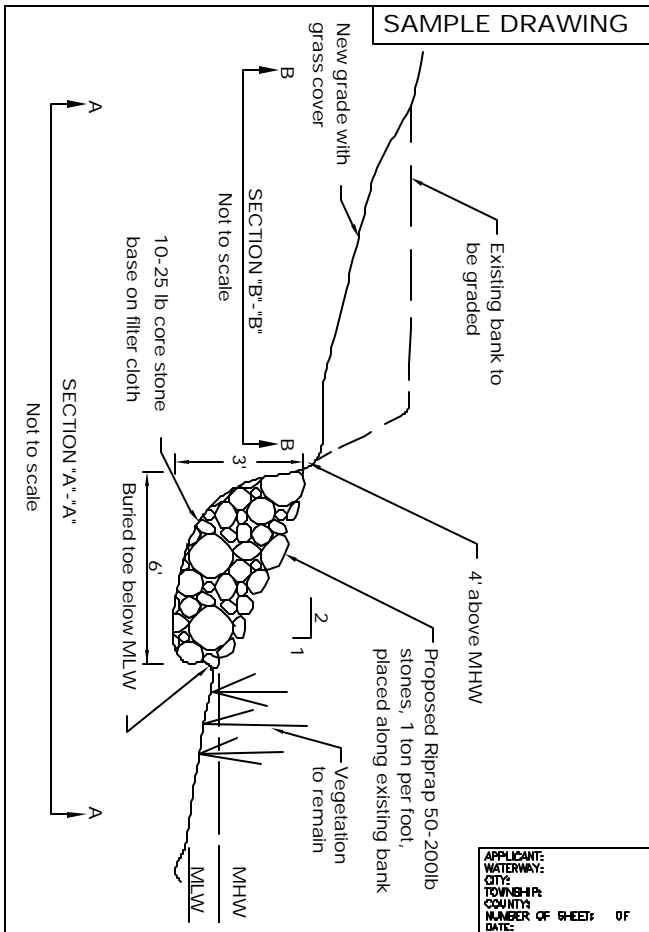

Riprap Revetment & Associated Backfill



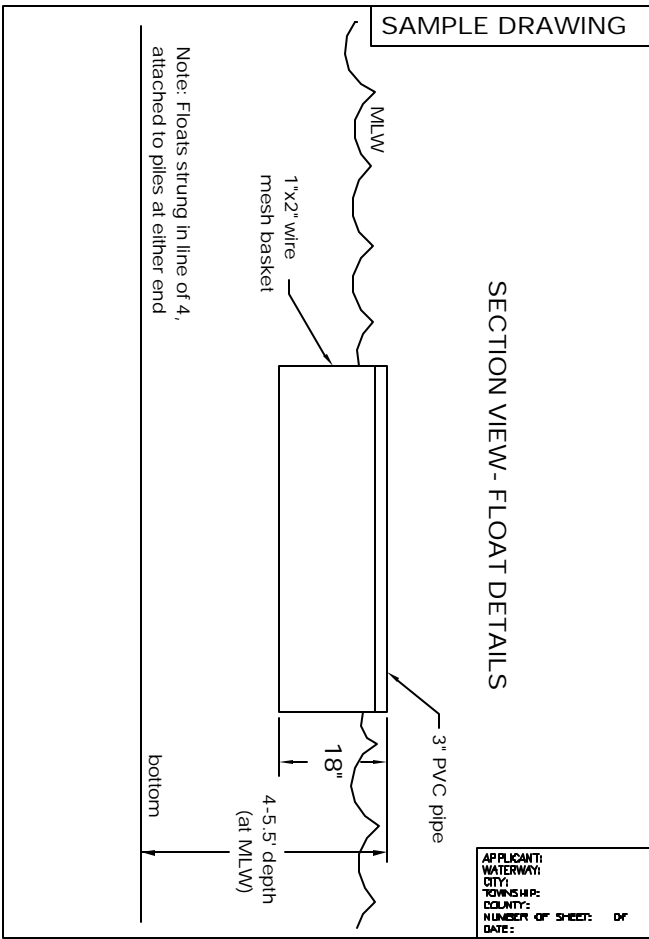
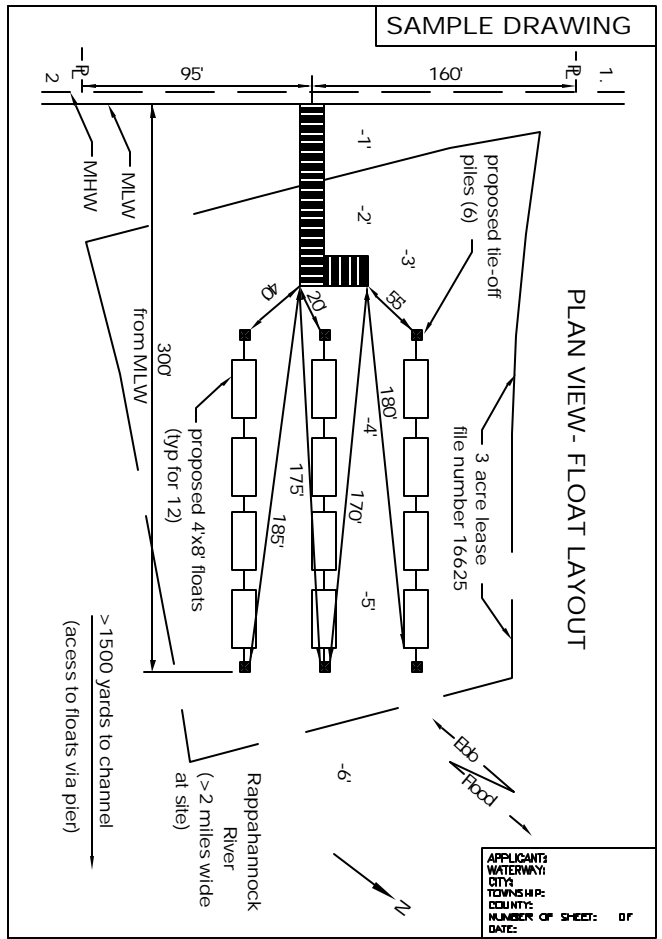

Private & Commercial Aquaculture Activities

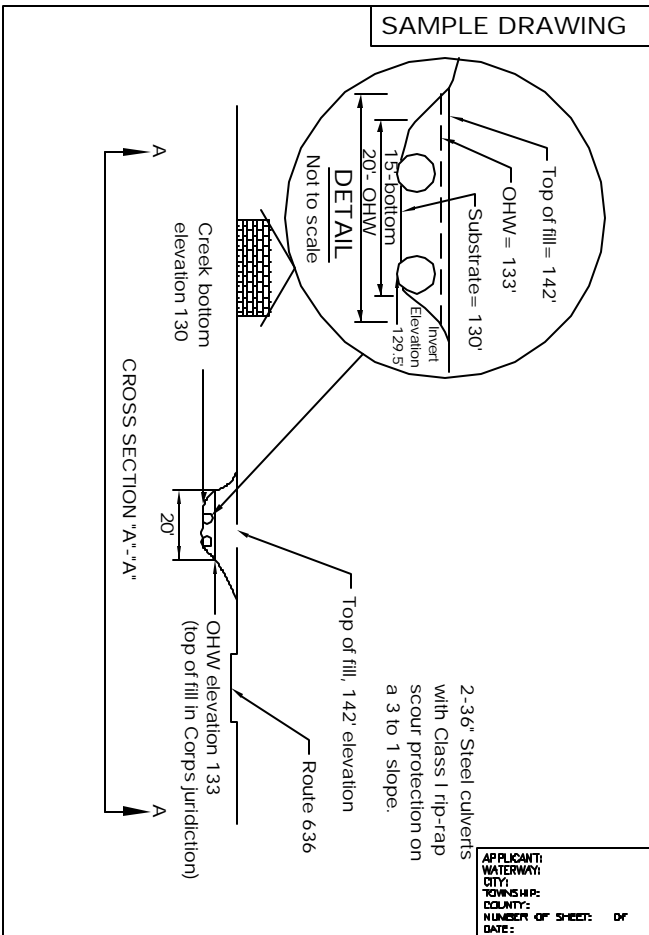
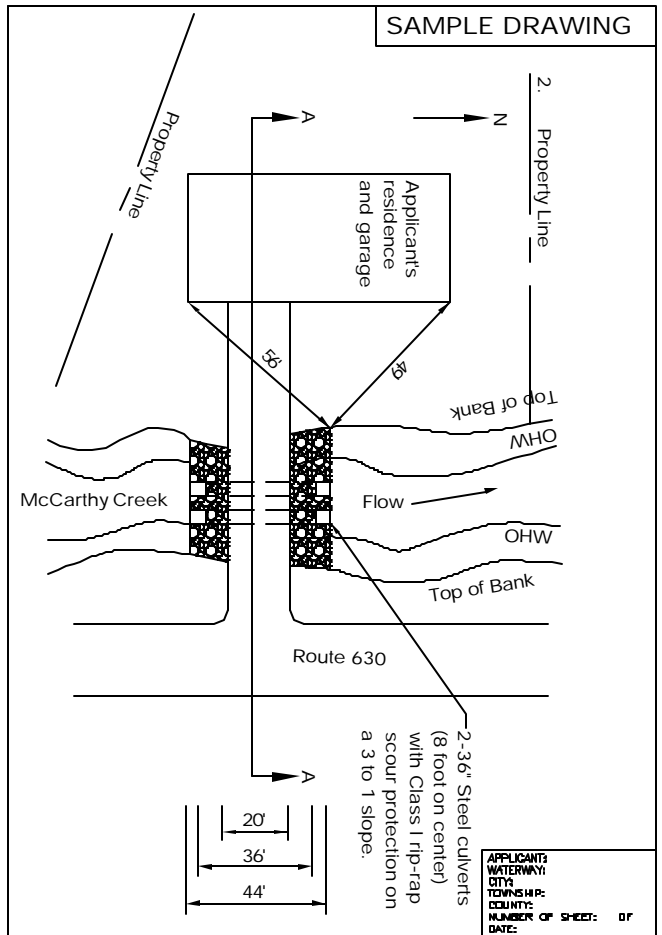

Road Crossings

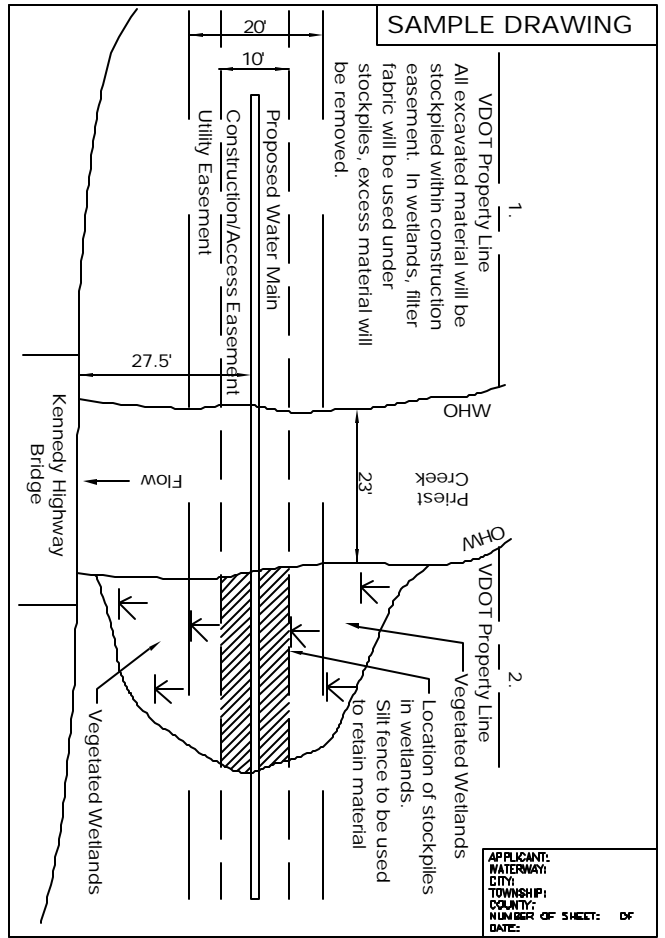
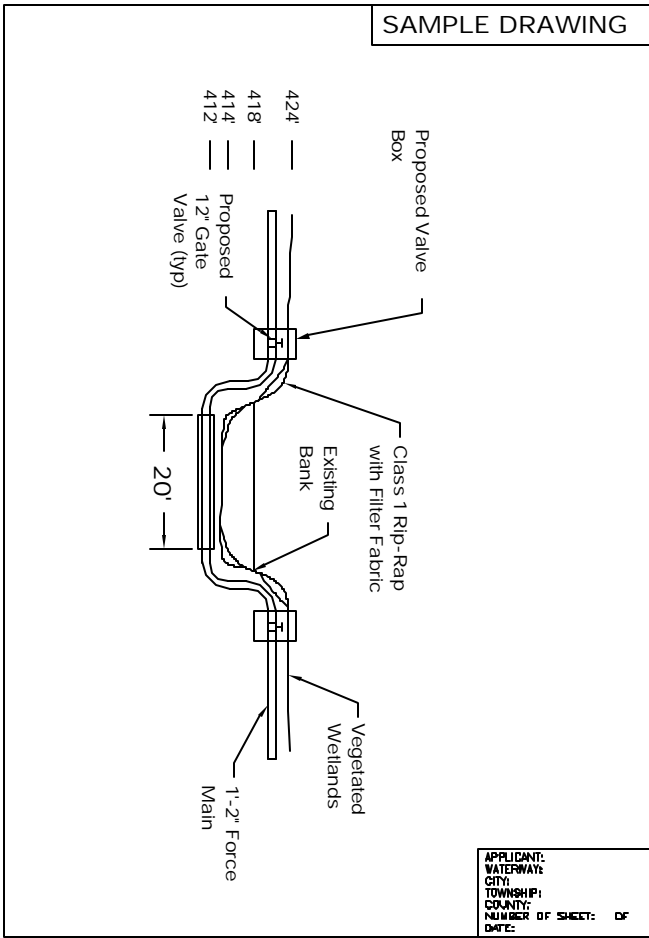

Utility Crossings

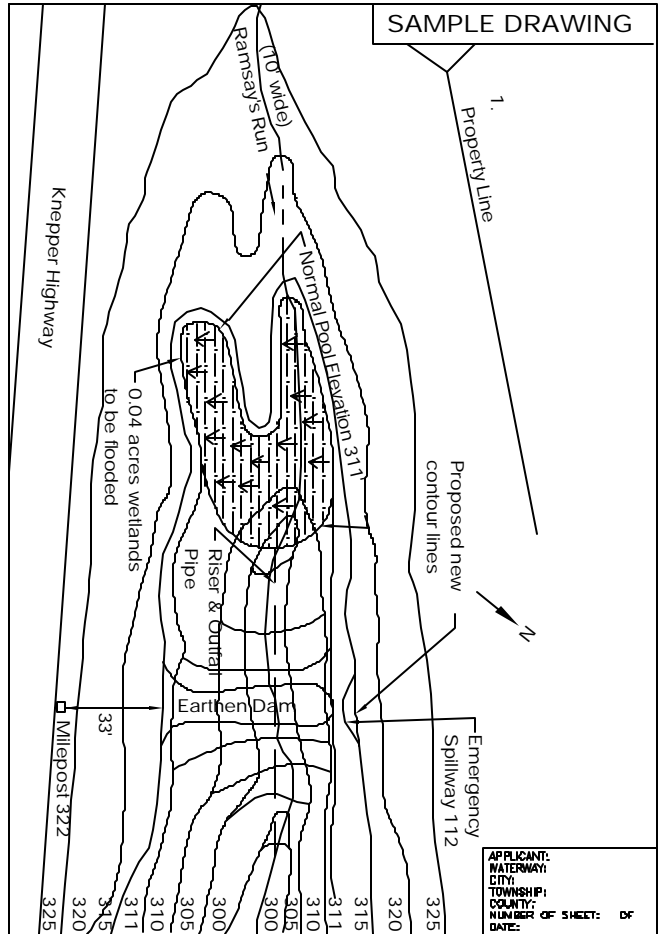
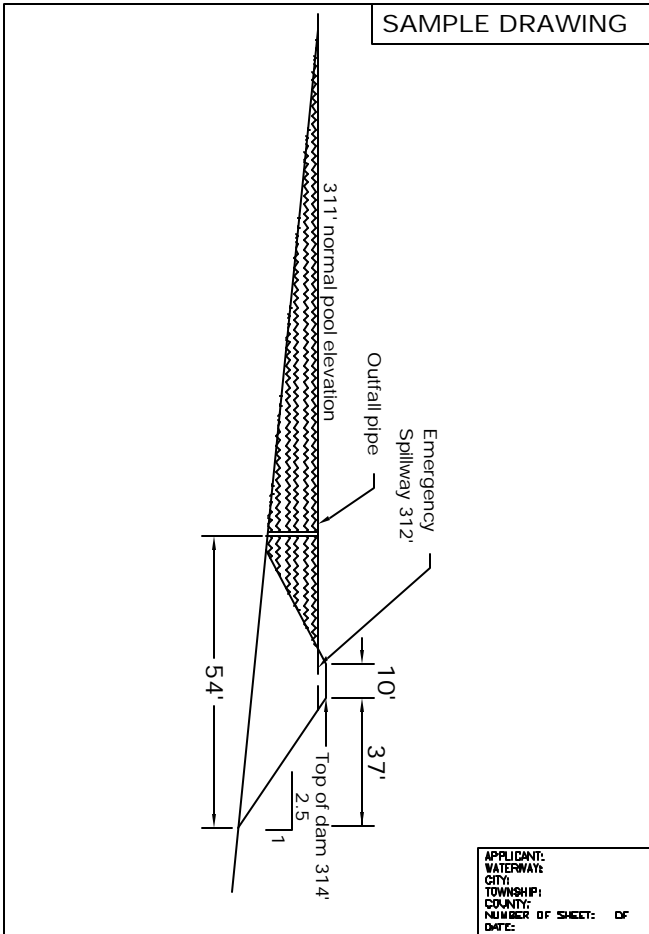

Impoundment/Dams